



**McElroy Manufacturing, Inc.**  
The leader by design.  
Tulsa, Oklahoma U.S.A.

DRAWN: BWW	CHECK: BWP	APPRV'D: JRP	DATE: 9/13/00	DWG No: T9017400	SHT No: 1	REV No: B	PART No: T9017401
TracStar® 900 PIPE STAND ASSEMBLY							CAD No: T9017401

NOTE: THIS DRAWING AND THE INFORMATION CONTAINED THEREIN IS THE CONFIDENTIAL AND PROPRIETARY PROPERTY OF McElroy Manufacturing, Inc. THE DRAWING IS NOT TO BE REPRODUCED IN ANY MANNER, SUBMITTED OUTSIDE PARTIES FOR EXAMINATION, OR USED DIRECTLY OR INDIRECTLY FOR THE PURPOSES OTHER THAN THOSE FOR WHICH IT WAS FURNISHED WITHOUT WRITTEN PERMISSION OF McElroy Manufacturing, Inc.

NOTES:

1. INSTALL ROLL PIN THROUGH EYE OF COTTER PIN TO A DEPTH OF 3/8" IN LEG. TYP. BOTH SIDES.
2. ITEMS IN PARENTHESIS REFLECT QUANTITIES IN A LOCAL GROUP AND MAY NOT INDICATE TOTAL ASSEMBLY QUANTITIES.
3. APPROX. WEIGHT: 175 LBS.

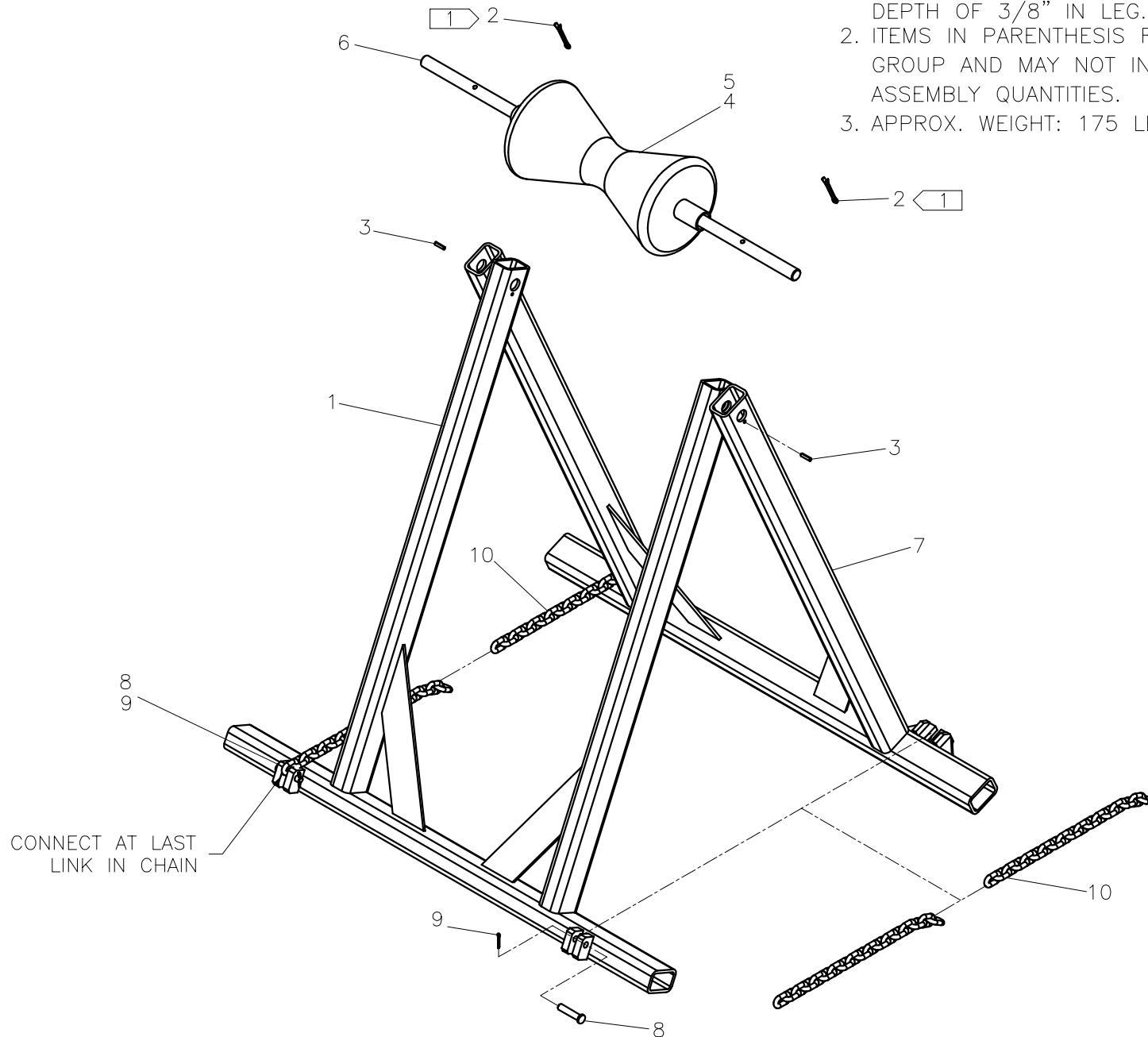

**TracStar® 900 PIPE STAND ASSEMBLY**PARTS LIST

ITEM	PART NO.	QTY	DESCRIPTION
	<b>T9017401</b>		<b>Assembly</b>
1	T9017402	1	PIPE STAND INNER LEG WELDMENT
2	MCH00006	2	1/4 x 2 LG COTTER PIN
3	MCG00008	2	1/4 x 1 LG ROLL PIN
4	MDM00018	2	FLANGE BUSHING
5	2423901	1	PIPE STAND ROLLER
6	T9017404	1	PIPE STAND ROLLER SHAFT
7	T9017403	1	PIPE STAND OUTER LEG WELDMENT
8	MCF00019	2	1/2 x 2-11/32 GRIP CLEVIS PIN
9	MCH00001	2	1/8 x 1 LG. COTTER PIN
10	4828601	2	CHAIN MODIFICATION

## DRAWING REVISION HISTORY LISTING

**PART NO:** T9017401

**DESCRIPTION:** TracStar® 900 PIPE STAND ASSEMBLY

<u>APPR.</u>	<u>REV</u>	<u>DATE</u>	<u>BY</u>	<u>DESCRIPTION OF REVISION</u>
SWB	A	4/23/04	ALK	CHANGED ITEM #10 MDG00021 3/8 SIZE CHAIN x 7 Ft. LG. TO 4828601 CHAIN MODIFICATION, DUE TO CHAIN BEING PURCHASED CUT.
SWB	B	10/13/05	BWW	CREATED EXPLODED ISOMETRIC VIEW AND ADDED NOTE 2 AND 3 FOR CLARITY.