



McElroy Manufacturing, Inc.
 The leader by design.
 Tulsa, Oklahoma U.S.A.

DRAWN: TLW	CHECK: TLW	APPRV'D: SWB	DATE: 12/09/98	DWG No: T5027100	SHT No: 1	REV No: C	PART No: T5027101
TracStar 500/500 II COACH 8" DIPS HEATER ASSEMBLY 220-240V, 50/60Hz, 1Ph							CAD No: T5027101

NOTE: THIS DRAWING AND THE INFORMATION CONTAINED THEREIN IS THE CONFIDENTIAL AND PROPRIETARY PROPERTY OF McElroy Manufacturing, Inc. THE DRAWING IS NOT TO BE REPRODUCED IN ANY MANNER, SUBMITTED OUTSIDE PARTIES FOR EXAMINATION, OR USED DIRECTLY OR INDIRECTLY FOR THE PURPOSES OTHER THAN THOSE FOR WHICH IT WAS FURNISHED WITHOUT WRITTEN PERMISSION OF McElroy Manufacturing, Inc.

ELECTRICAL SCHEMATIC

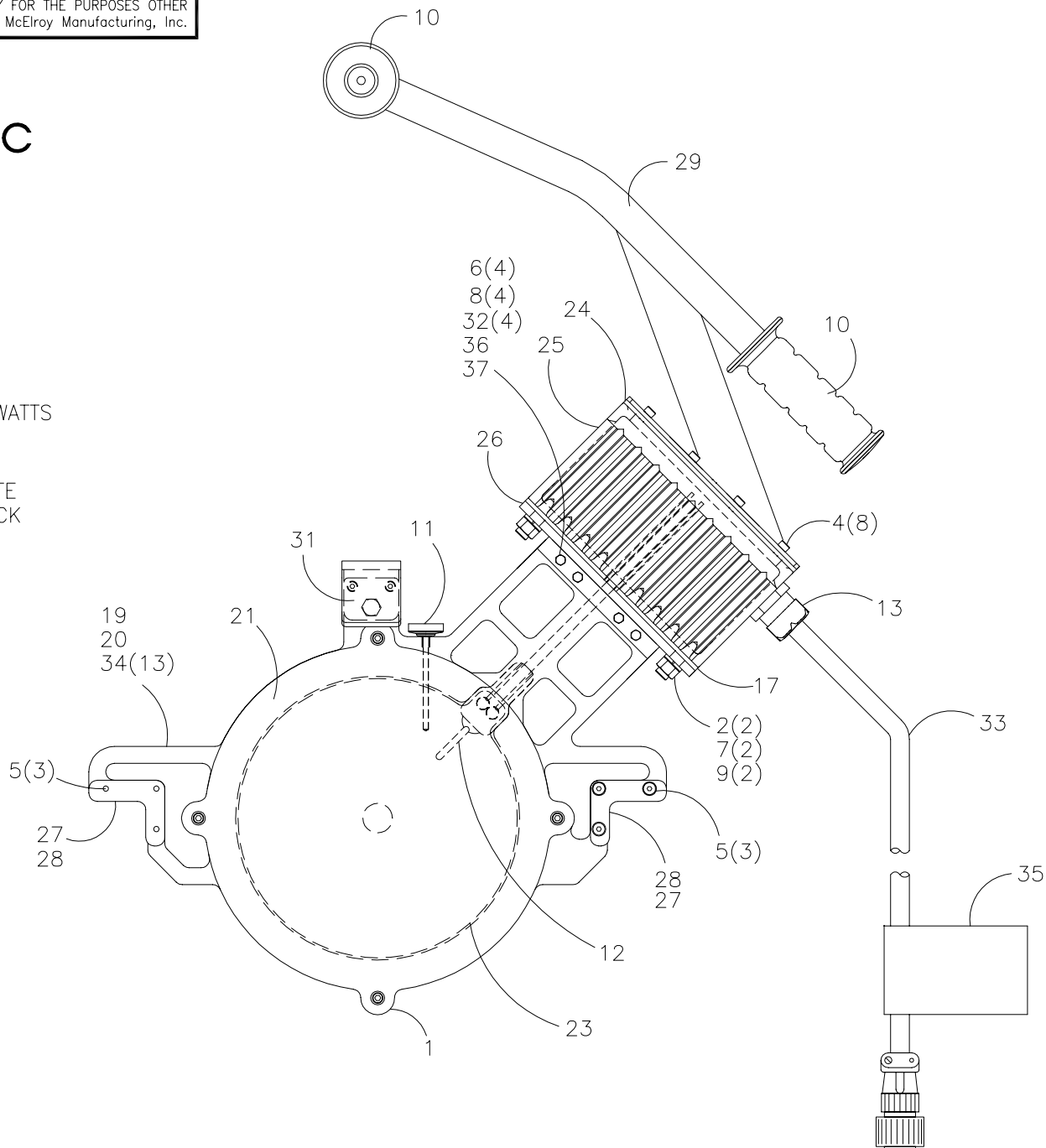
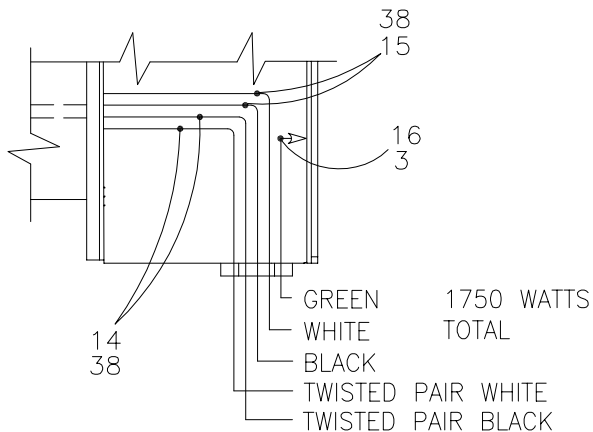

**TracStar 500/500 II COACH 8" DIPS HEATER ASSEMBLY
220-240V,50/60Hz,1Ph**

Parts List

ITEM	PART NO.	QTY.	DESCRIPTION
	T5027101	1	ASSEMBLY
1	A848706	1	8 DIPS HEATER BUTT PLATE KIT
2	MAC00095	2	3/8-16NC X 1-1/4"LG SHCS
3	MAH00030	1	#10-24NC X 1/4"LG RHSMS SS
4	MAH00046	8	#10-24 X 1/2"LG SHCS SS
5	MAN00016	6	#10-32NF X 3/4"LG FHSCS SS
6	MBA00004	4	#10-24NC FINISHED HEX NUT
7	MBA00007	2	3/8-16NC FINISHED HEX NUT
8	MBE00004	4	#10 REGULAR SPLIT LOCK WASHER
9	MBE00007	2	3/8" REGULAR SPLIT LOCK WASHER
10	MJJ00009	2	HAND GRIP
11	MJK00002	1	THERMOMETER
12	MKI00003	1	100 OHM PLATINUM RTD
13	MLK00022	1	1/2" STRAIN RELIEF CONNECTOR
14	MJQ00046	2	FERRULE
15	MJQ00026	2	FERRULE
16	MLM00013	1	CONNECTOR
17	1207302	1	HEATER GASKET
18			
19	848703	1	RIGHT HEATER BODY
20	848704	1	LEFT HEATER BODY
21	848705	1	HEATER O.D. SPACER
22			
23	838009	1	220V MICA/FOIL HEATER ELEMENT
24	1808102	1	HEATER GASKET
25	1810905	1	8 HEATER TERMINAL BOX
26	1852008	1	HEATER TERMINAL ENCLOSURE ADAPTER BRACKET
27	1852011	2	HEATER GUIDE ROD SUPPORT BRACKET
28	1852012	2	HEATER GUIDE ROD SUPPORT BRACKET
29	838007	1	HEATER HANDLE WELDMENT
30			
31	A848707	1	STRIPPER BAR KIT
32	MAN00008	4	#10-24NC X 1" LG SHCS SS
33	T5022401	1	LIGHT WEIGHT HEATER CORD
34	MAN00023	13	#8-32NC X 5/16 LG SHCS SS
35	410906	1	DANGER NOT EXPLOSION PROOF TAG LABEL
36	1852017	1	HEATER .004 THICK SHIM
37	1852018	1	HEATER .018 THICK SHIM
38	MLN00219	1ft	FIBERGLASS TAPE

DRAWING REVISION HISTORY LISTING

PART NO: T5027101

DESCRIPTION: TracStar 500/500 II COACH 8" DIPS HEATER ASSEMBLY 220-240V, 50/60Hz, 1Ph

<u>APPR.</u>	<u>REV</u>	<u>DATE</u>	<u>BY</u>	<u>DESCRIPTION OF REVISION</u>
TLW	A	1/19/99	TGW	ADDED SHIMS - ITEMS 36 (1852017) & 37 (1852018).
SWB	-	04/17/00	TLW	REVISED ITEM #5 MAN00016 #10-32NF X 3/4 LG FHSCS SS TO MAN00036 #10-32NF X 7/8 LG FHSCS SS. DUE TO STACK-UP OF TOLERANCES, MAN00016 COULD BE TOO SHORT.
RAD	B	09/14/01	BWW	REVISED TO CHANGE ITEM 14 FROM MLM00002 TO MJQ00046 AND ITEM 15 FROM MLM00010 TO MJQ00026, ALSO ADDED ITEM 38 MLN00219 TO IMPROVE TEMPERATURE RESISTANCE OF WIRE SPLICES.
BWJ	C	04/11/02	BWW	REVISED TO UPDATE DESCRIPTION TO INCLUDE T500 II COACH MACHINE AND UPDATE ITEM 29 TO NEW DESIGN.