



**McElroy Manufacturing, Inc.**  
 The leader by design.  
 Tulsa, Oklahoma U.S.A.

DRAWN: TLW	CHECK: DWP	APPRV'D: JRP	DATE: 08/17/00	DWG No: T1201600	SHT No: 1	REV No: B	PART No: T1201601
LIFTING SLING							CAD No: T1201601

NOTE: THIS DRAWING AND THE INFORMATION CONTAINED THEREIN IS THE CONFIDENTIAL AND PROPRIETARY PROPERTY OF McElroy Manufacturing, Inc. THE DRAWING IS NOT TO BE REPRODUCED IN ANY MANNER, SUBMITTED OUTSIDE PARTIES FOR EXAMINATION, OR USED DIRECTLY OR INDIRECTLY FOR THE PURPOSES OTHER THAN THOSE FOR WHICH IT WAS FURNISHED WITHOUT WRITTEN PERMISSION OF McElroy Manufacturing, Inc.

NOTES:

1. SLING ASSEMBLY LOAD RATING 2000 LBS AT 60°.
2. PROOF TEST SLING ASSEMBLY TO 4000 LBS AT 60° AND TAG.
3. CABLE LEG ASSEMBLY TO HAVE MECHANICAL SPLICES AND HEAVY-DUTY THIMBLES BOTH ENDS.
4. THIS LIFTING SLING IS PROOF TESTED & CERTIFIED TO LIFT THE SPECIFIED LOAD SHOWN ON THE DRAWING. REPLACEMENT PARTS ARE AVAILABLE ONLY BY SENDING THE ENTIRE LIFTING SLING BACK TO McELROY. AFTER THE REPLACEMENT PARTS HAVE BEEN INSTALLED THE LIFTING SLING WILL BE PROOF TESTED AGAIN & RE-CERTIFIED.

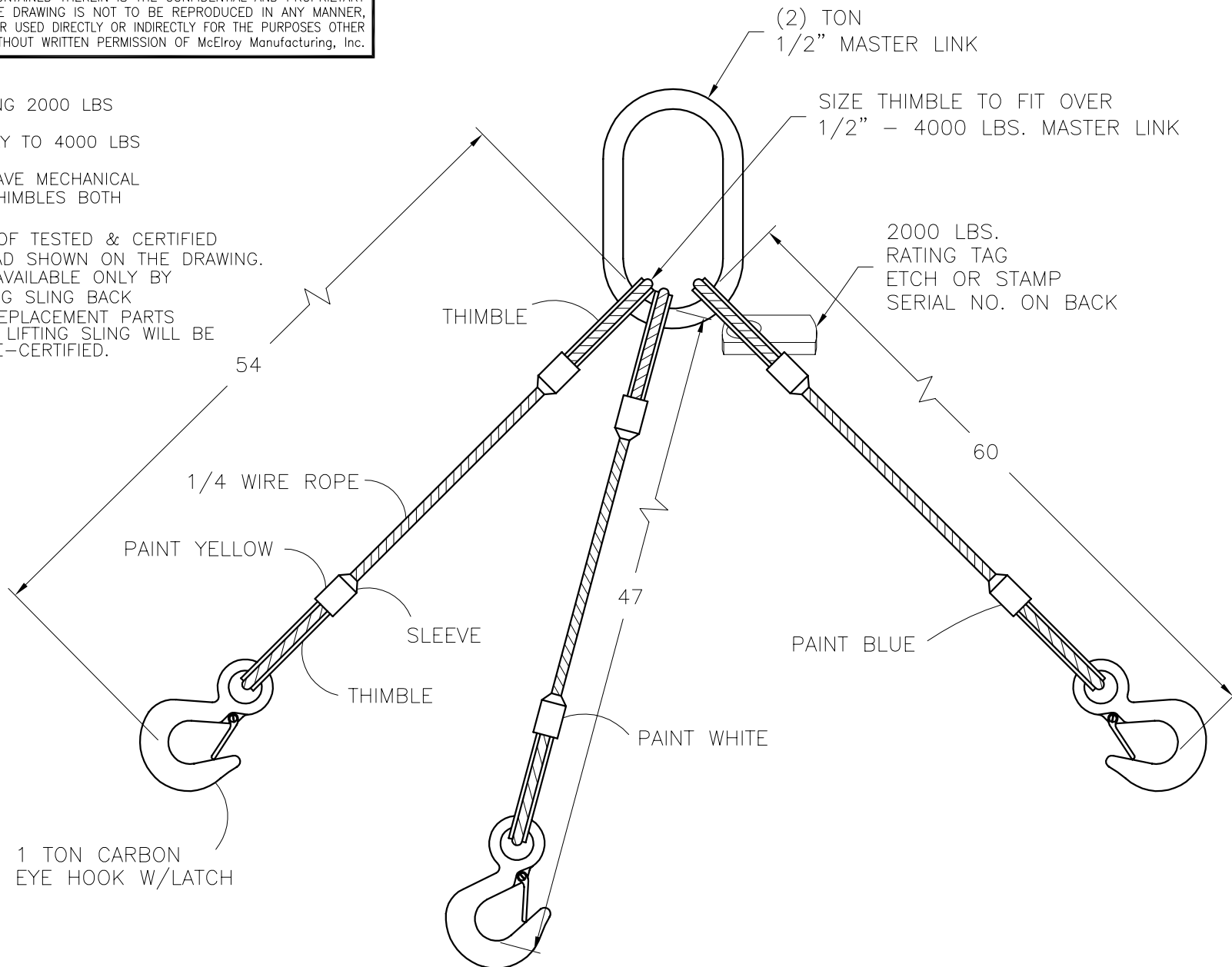

## DRAWING REVISION HISTORY LISTING

**PART NO:** T1201601  
**DESCRIPTION:** LIFTING SLING

<u>APPR.</u>	<u>REV</u>	<u>DATE</u>	<u>BY</u>	<u>DESCRIPTION OF REVISION</u>
SWB	A	10/7/01	ALK	ADDED PAINT NOTE TO 2 SLING SLEEVES TO COLOR CODE ATTACHMENT POINTS.
SWB	B	03/07/02	BWW	REVISED TO CHANGE PAINTED BLACK SLEEVE TO WHITE PAINT AND ADD BLUE PAINT TO REMAINING UNPAINTED SLEEVE TO ALLOW CUSTOMER TO MORE EASILY IDENTIFY LIFTING POINTS.