



McElroy Manufacturing, Inc.
 The leader by design.
 Tulsa, Oklahoma U.S.A.

DRAWN: JPS CHECK: JAL APPRV'D: JRP DATE: 12/17/97 DWG No: LT0106 SHT No: 1A REV No: C PART No: LT0106

Line Tamer™ 5HP GAS HYDRAULIC POWER UNIT ASSEMBLY

CAD No: LT0106

NOTE: THIS DRAWING AND THE INFORMATION CONTAINED THEREIN IS THE CONFIDENTIAL AND PROPRIETARY PROPERTY OF McElroy Manufacturing, Inc. THE DRAWING IS NOT TO BE REPRODUCED IN ANY MANNER, SUBMITTED TO OUTSIDE PARTIES FOR EXAMINATION, OR USED DIRECTLY OR INDIRECTLY FOR THE PURPOSES OTHER THAN THOSE FOR WHICH IT WAS FURNISHED WITHOUT WRITTEN PERMISSION OF McElroy Manufacturing, Inc.

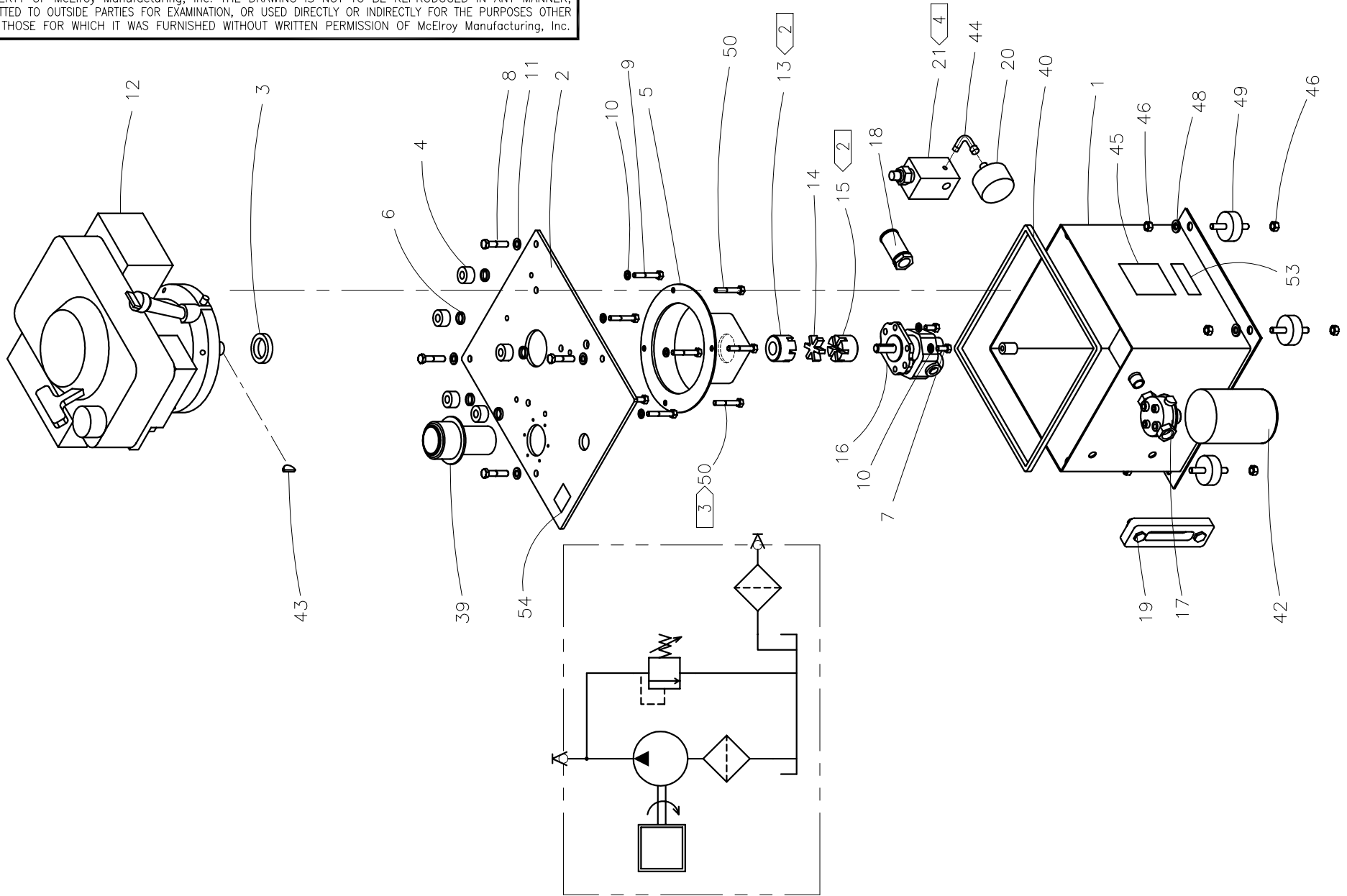

UNLESS NOTED OTHERWISE: (3) PLC. DIM'S .XXX = ±0.005" (2) PLC. DIM'S .XX = ±0.010" FRACTIONAL DIM'S = ±1/32"

ANGULAR DIM'S = ±1/4" REMOVE ALL BURRS BREAK ALL SHARP EDGES

STAMP OR ETCH P/N ON ALL DETAIL PARTS

MMI NUMBER	ITEM	QTY.	SIZE AND DESCRIPTION



McElroy Manufacturing, Inc.

The leader by design.

Tulsa, Oklahoma U.S.A.

DRAWN: JPS

CHECK: JAL

APPRV'D: JRP

DATE: 12/17/97

DWG No: LT0106

SHT No: 1B

REV No: C

PART No: LT0106

Line Tamer™ 5HP GAS HYDRAULIC POWER UNIT ASSEMBLY

CAD No: LT0106

NOTE: THIS DRAWING AND THE INFORMATION CONTAINED THEREIN IS THE CONFIDENTIAL AND PROPRIETARY PROPERTY OF McElroy Manufacturing, Inc. THE DRAWING IS NOT TO BE REPRODUCED IN ANY MANNER, SUBMITTED TO OUTSIDE PARTIES FOR EXAMINATION, OR USED DIRECTLY OR INDIRECTLY FOR THE PURPOSES OTHER THAN THOSE FOR WHICH IT WAS FURNISHED WITHOUT WRITTEN PERMISSION OF McElroy Manufacturing, Inc.

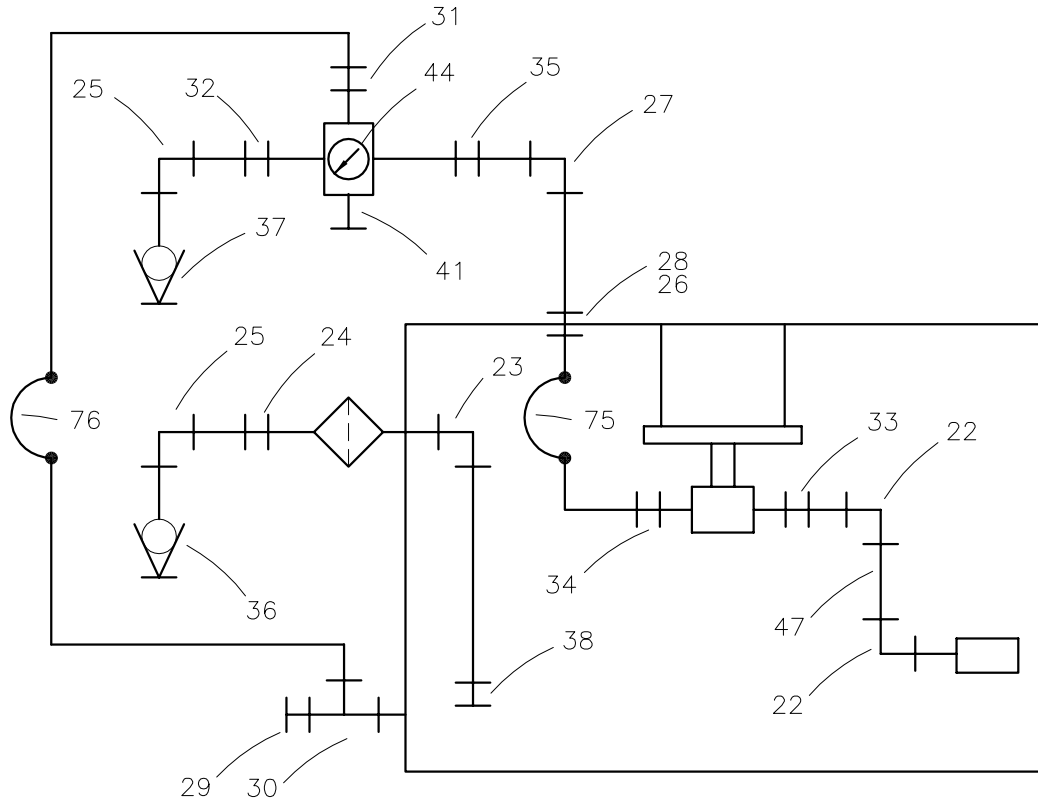

UNLESS NOTED OTHERWISE: (3) PLC. DIM'S .XXX = ±0.005" (2) PLC. DIM'S .XX = ±0.010" FRACTIONAL DIM'S = ±1/32"

ANGULAR DIM'S = ±1/4" REMOVE ALL BURRS BREAK ALL SHARP EDGES

STAMP OR ETCH P/N ON ALL DETAIL PARTS

MMI NUMBER	ITEM	QTY.	SIZE AND DESCRIPTION

**LineTamer™ 5HP GAS
HYDRAULIC POWER UNIT ASSEMBLY**

Parts List

ITEM	PART NO.	QTY.	DESCRIPTION
	LT0106		ASSEMBLY
1	LT0050	1	HYDRAULIC RESERVOIR
2	LT0107	1	HYDRAULIC RESERVOIR COVER
3	LT0108	1	ENGINE SHAFT SEAL
4	LT0109	5	STANDOFF
5	MEA00002	1	PUMP ADAPTER
6	MBG00056	5	5/16" SEAL WASHER
7	MAA00032	4	5/16-18NC X 3/4"LG HHCS
8	MAA00067	4	3/8-16NC X 1-3/4"LG HHCS
9	MAA00422	5	5/16-24NF X 1 1/2"LG HHCS
10	MBE00006	9	5/16" REG SPLIT LK WASHER
11	MBG00060	4	3/8" SEAL WASHER
12	MDA00047	1	5 HP GASOLINE ENGINE
13	MDJ00045	1	COUPLING HALF
14	MDJ00046	1	COUPLING INSERT
15	MDJ00047	1	COUPLING HALF
16	MEA00051	1	BI-ROTATIONAL GEAR PUMP
17	MED00045	1	FILTER HEAD
18	MED00046	1	SUCTION STRAINER
19	MEE00014	1	SIGHT GAUGE W/THERMOMETER
20	MEE00042	1	PRESSURE GAUGE
21	MEH00012	1	RELIEF VALVE
22	MFA00022	2	8MPT/8FPT ELBOW
23	MFA00023	1	8FPT/8FPT ELBOW
24	MFA00026	1	8MPT/4FPT REDUCER
25	MFA00140	2	4MPT/4MPT ELBOW
26	MDL00192	1	O-RING
27	MFB00012	1	6MJIC/6FSJIC ELBOW
28	MFB00014	1	6MJIC/6MJIC ADAPTER
29	MFB00117	1	8FJIC CAP
30	MFB00147	1	8MPT/8MJIC/8MJIC TEE
31	MFC00002	1	6MSAE/6MJIC ADAPTER
32	MFC00005	1	4FPT/6MSAE ADAPTER
33	MFC00015	1	8MSAE/8FPT ADAPTER
34	MFC00027	1	8MSAE/6MJIC ADAPTER
35	MFC00080	1	6MSAE/6FJICS SWIVEL ADAPTER

**LineTamer™ 5HP GAS
HYDRAULIC POWER UNIT ASSEMBLY**

Parts List

ITEM	PART NO.	QTY.	DESCRIPTION
36	MFH00001	1	1/4"FPT QUICK DISCONNECT COUPLER
37	MFH00002	1	1/4"FPT QUICK DISCONNECT NIPPLE
38	MFI00032	1	1/2" NPT X 6" LG. XHS NIPPLE
39	MFK00001	1	FILLER CAP
40	LT0052	1	HYDRAULIC RESERVOIR SEAL
41	MFA00007	1	4MPT PLUG
42	MED00017	1	FILTER ELEMENT
43	MCK00036	1	5/32" X 5/8" WOODRUFF KEY #505
44	MFA00008	1	4MPT/4FPT ELBOW
45	LT0039	1	MMI LOGO LABEL
46	MBC00007	8	3/8-16NC FINISHED HEX NYLON LOCK NUT
47	MFI00027	1	1/2" NPT. CLOSE XHS NIPPLE
48	MBF00007	4	3/8" TYPE 'A' WIDE FLAT WASHER
49	MDR00071	4	SHOCK MOUNT
50	MAA00063	4	3/8-16NC X 3/4" LG.
51	MRA00004	1	5HP HONDA ENGINE OWNER'S MANUAL (NOT SHOWN)
52	ALT0070	1	GAS HYD. POWER UNIT HOSE KIT (NOT SHOWN)
53	LT0134	1	Linetamer LT0106 IDENTIFICATION LABEL
54	8163106	1	HYDRAULIC OIL SPECIFICATION LABEL

NOTES:

1. FOR HOSE ASSEMBLIES (ITEMS #75 & LARGER) SEE LineTamer GAS HYDRAULIC POWER UNIT HOSE KIT #ALT0070.
2. INSTALL WITH THREAD LOCKING COMPOUND.
3. INSTALL WITH THREAD SEALING COMPOUND.
4. SET RELIEF VALVE PRESSURE TO 2500 PSI.

DRAWING REVISION HISTORY LISTING

PART NO: LT0106

DESCRIPTION: LineTamer™ 5HP GAS HYDRAULIC POWER UNIT ASSEMBLY

<u>APPR.</u>	<u>REV</u>	<u>DATE</u>	<u>BY</u>	<u>DESCRIPTION OF REVISION</u>
TLW	A	6/5/98	TGW	ADDED ITEM 53 ID LABEL P/N LT0134.
SWB	B	11/02/04	BWW	ADDED ITEM 54 8163106 QTY 1 FOR HYDRAULIC OIL SPECIFICATION INFORMATION.
BLM	C	12/23/04	JAB	ADDED NOTE 4 FOR SETTING CORRECT PRESSURE DURING ASSEMBLY.