

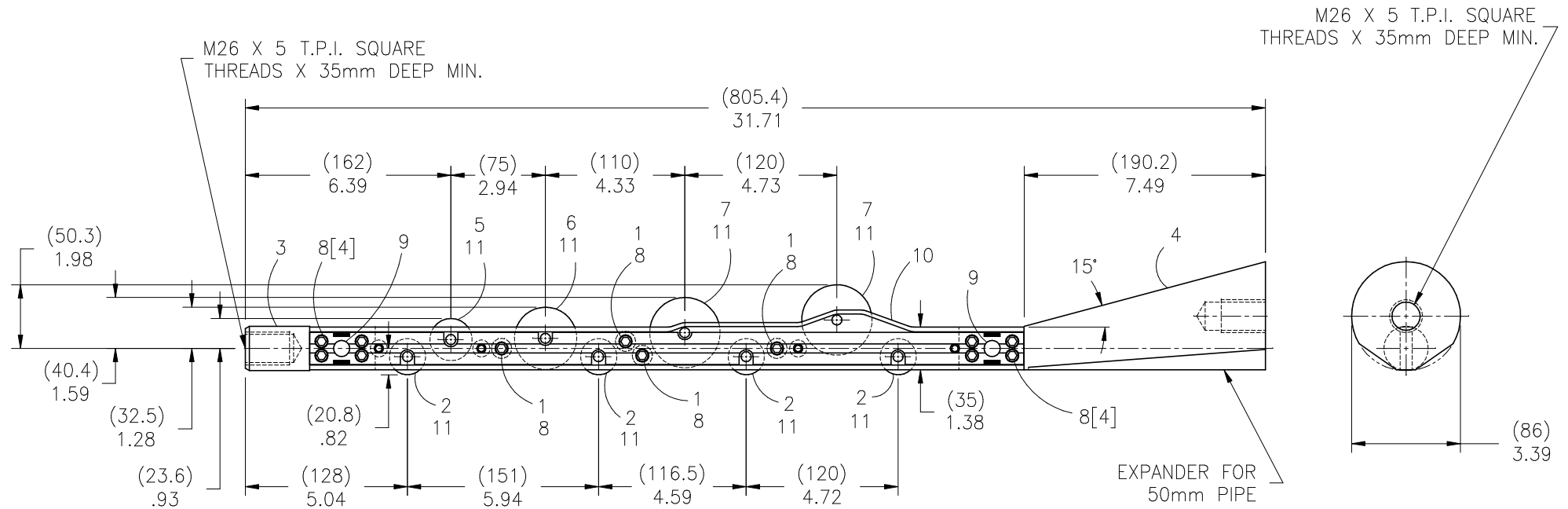

**McElroy Manufacturing, Inc.**  
 The leader by design.  
 Tulsa, Oklahoma U.S.A.

DRAWN: TLW	CHECK: doug	APPRV'D: B	DATE: 7/18/95	DWG No: B150-3000	SHT No: 1	REV No: C	PART No: B150-3001
1 1/2" JIS Bullet ASSEMBLY							CAD FILE No: B150-3001

- APPROVED AS DRAWN \_\_\_\_\_ DATE \_\_\_\_\_
- REVISED AS NOTED \_\_\_\_\_ DATE \_\_\_\_\_



**NOTES:**

1. DIMENSIONS IN ( ) ARE IN MILLIMETERS. ALL OTHER DIMENSIONS ARE IN INCHES.

NOTE: This drawing and the information contained therein is the confidential and proprietary property of McElroy Manufacturing, Inc. The drawing is not to be reproduced in any manner, submitted to outside parties for examination, or used directly or indirectly for purposes other than those for which it was furnished without written permission of McElroy Manufacturing, Inc.

**1 1/2" JIS Bullet™ ASSEMBLY**Parts List

ITEM	PART NO.	QTY.	DESCRIPTION
	<b>B150-3001</b>	<b>1</b>	<b>ASSEMBLY</b>
1	B150-1801	4	SPLITTER BODY SPACER
2	B150-1901	4	GUIDE ROLLER
3	B150-3101	1	JIS NOSE CONE
4	B150-3201	1	50MM JIS EXPANDER
5	B150-3701	1	1-5/16" DIA. JIS CUTTER WHEEL
6	B150-3702	1	1-15/16" DIA. JIS CUTTER WHEEL
7	B150-3703	2	2-3/16" DIA. JIS CUTTER WHEEL
8	MAC00053	12	1/4-20NC X 3/4"LG SHCS STL BL
9	MCI00022	2	1/2" DIA X 1-1/4"LG DOWEL PIN
10	B150-3801	1	1-1/2" JIS SPLITTER BODY SET
11	MCI00023	8	5/16" DIA X 1"LG DOWEL PIN

**NOTES:**

2. INSTALL ALL BOLTS WITH LOCTITE #242.