

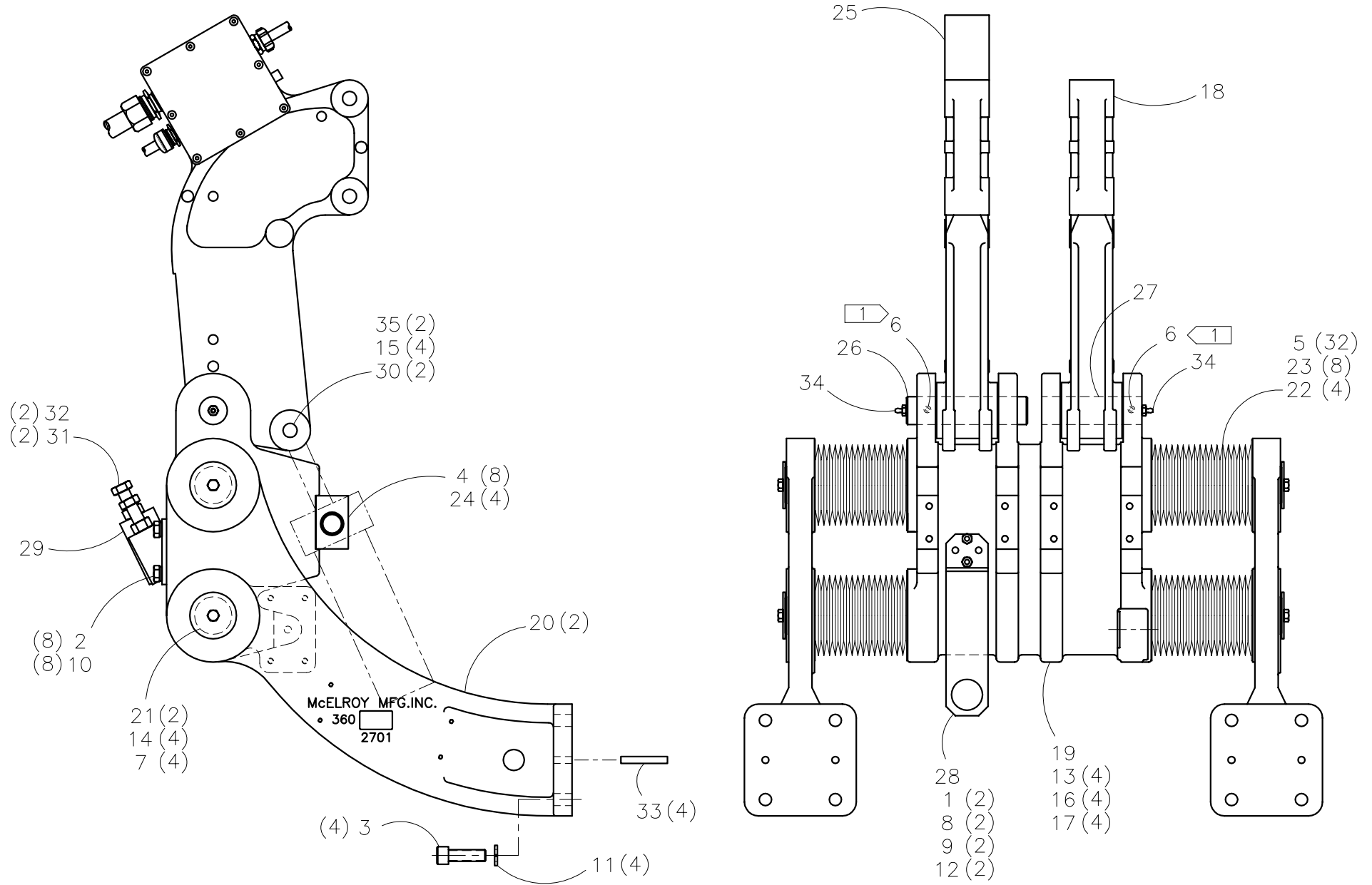

McElroy Manufacturing, Inc.
 The leader by design.
 Tulsa, Oklahoma U.S.A.

DRAWN: TGW	CHECK: TLW	APPRV'D: SWB	DATE: 10/2/98	DWG No: 3631500	SHT No: 1	REV No: A	PART No: 3631501
#1236A INDEXING CARRIAGE ASSEMBLY							CAD No: 3631501

NOTE: THIS DRAWING AND THE INFORMATION CONTAINED THEREIN IS THE CONFIDENTIAL AND PROPRIETARY PROPERTY OF McElroy Manufacturing, Inc. THE DRAWING IS NOT TO BE REPRODUCED IN ANY MANNER, SUBMITTED TO OUTSIDE PARTIES FOR EXAMINATION, OR USED DIRECTLY OR INDIRECTLY FOR THE PURPOSES OTHER THAN THOSE FOR WHICH IT WAS FURNISHED WITHOUT WRITTEN PERMISSION OF McElroy Manufacturing, Inc.



#1236A INDEXING CARRIAGE ASSEMBLYPARTS LIST

ITEM	PART NO.	QTY	DESCRIPTION
	3631501		ASSEMBLY
1	MAA00034	2	5/16-18 NC X 1-1/4" LG. HHCS
2	MAA00126	8	1/2-13 NC X 1-1/2" LG. HHCS
3	MAC00165	8	5/8-11 NC X 2" LG. SHCS
4	MAC00338	8	3/8-24 NF X 2" LG. SHCS
5	MAE00009	32	#6-32 NC X 3/8" LG. BHSCS
6	MAG00011	2	1/4-20 NC X 3/4" LG. CONE PT SS
7	MAB00077	4	3/8-16NC X 1" LG HHCS
8	MBA00006	2	5/16-18 NC HEX NUT
9	MBE00006	2	5/16" LOCK WASHER
10	MBE00009	8	1/2" LOCK WASHER
11	MBE00011	8	5/8" LOCK WASHER
12	MBF00006	2	5/16" FLAT WASHER
13	MCA00002	4	INT SNAP RING
14	MBG00064	4	3/8" SPECIAL FLAT WASHER
15	MCH00001	4	1/8" DIA. X 1" LG. COTTER PIN
16	MDL00047	4	SEAL
17	MDM00037	4	BALL BUSHING
18	3602203	1	FACER PIVOT ARM ASSEMBLY
19	3602602	1	INDEXING CARRIAGE
20	3602704	2	CARRIAGE SUPPORT ARM
21	3605703	2	CARRIAGE SUPPORT SHAFT
22	3605901	4	INDEXING CARRIAGE BOOT
23	3605902	8	INDEXING CARRIAGE BOOT FLANGE
24	3607101	4	INDEXING CARRIAGE TRUNNION FITTING
25	3608003	1	PIVOT ARM/JUNCTION BOX - HEATER
26	3609101	1	HEATER PIVOT ARM SHAFT
27	3610101	1	FACER PIVOT ARM SHAFT
28	3611301	1	ELECTRICAL CABLE MOUNT BRACKET
29	3614004	1	HEATER/FACER STOP BRACKET
30	3617101	2	CYLINDER ROD CLEVIS PIN
31	MAA00158	2	5/8-11NC X 2-1/4" LG HHCS
32	MBA00011	2	5/8-11NC HEX NUT
33	MCI00002	4	3/8" DIA X 1-1/2" LG DOWEL PIN
34	MFJ00001	2	1/4-28NF GREASE ZERK
35	1237301	2	FEMALE ROD EYE

NOTES:

1. INSTALL WITH LOCTITE 242.

DRAWING REVISION HISTORY LISTING

PART NO: 3631501
DESCRIPTION: #1236A INDEXING CARRIAGE ASSEMBLY

<u>APPR.</u>	<u>REV</u>	<u>DATE</u>	<u>BY</u>	<u>DESCRIPTION OF REVISION</u>
SWB	A	01/11/05	BWW	ADDED NOTE 1 TO LOCTITE AT ASSEMBLY TO MATCH AS BUILT CONDITION.