



#1236A FACER ASSEMBLY

NOTE: THIS DRAWING AND THE INFORMATION CONTAINED THEREIN IS THE CONFIDENTIAL AND PROPRIETARY PROPERTY OF McElroy Manufacturing, Inc. THE DRAWING IS NOT TO BE REPRODUCED IN ANY MANNER, SUBMITTED OUTSIDE PARTIES FOR EXAMINATION, OR USED DIRECTLY OR INDIRECTLY FOR THE PURPOSES OTHER THAN THOSE FOR WHICH IT WAS FURNISHED WITHOUT WRITTEN PERMISSION OF McElroy Manufacturing, Inc.

NOTES:

1. PACK BEARINGS WITH EP GREASE.
2. INSTALL WITH MEDIUM STRENGTH THREAD LOCKING COMPOUND.
3. FILL FACER CAVITY 2/3 FULL WITH EP GREASE.
4. INSTALL WITH HIGH TEMPERATURE ANTI-SEIZE COMPOUND.
5. INSTALL GASKET SEALER.
6. HYDRAULIC MOTOR FURNISHED WITH 5/16" SQ. KEY x 1-1/4" LG. FOR REPLACEMENT KEY ORDER MCK00052.
- 7.
8. ITEM #40 3631101 IS ROLLED AND PAINTED ONLY. MOUNTING TABS AND HOLES MUST BE FORMED AND DRILLED $\phi 7/32$ THRU TO FIT AT ASSEMBLY.
9. ITEMS SHOWN IN PARENTHESIS REFLECT QUANTITIES IN A LOCAL GROUP AND MAY NOT INDICATE TOTAL ASSEMBLY QUANTITIES.
10. FOR BLADE SET ORDER 3615707 WHICH INCLUDES (6) 3615706.

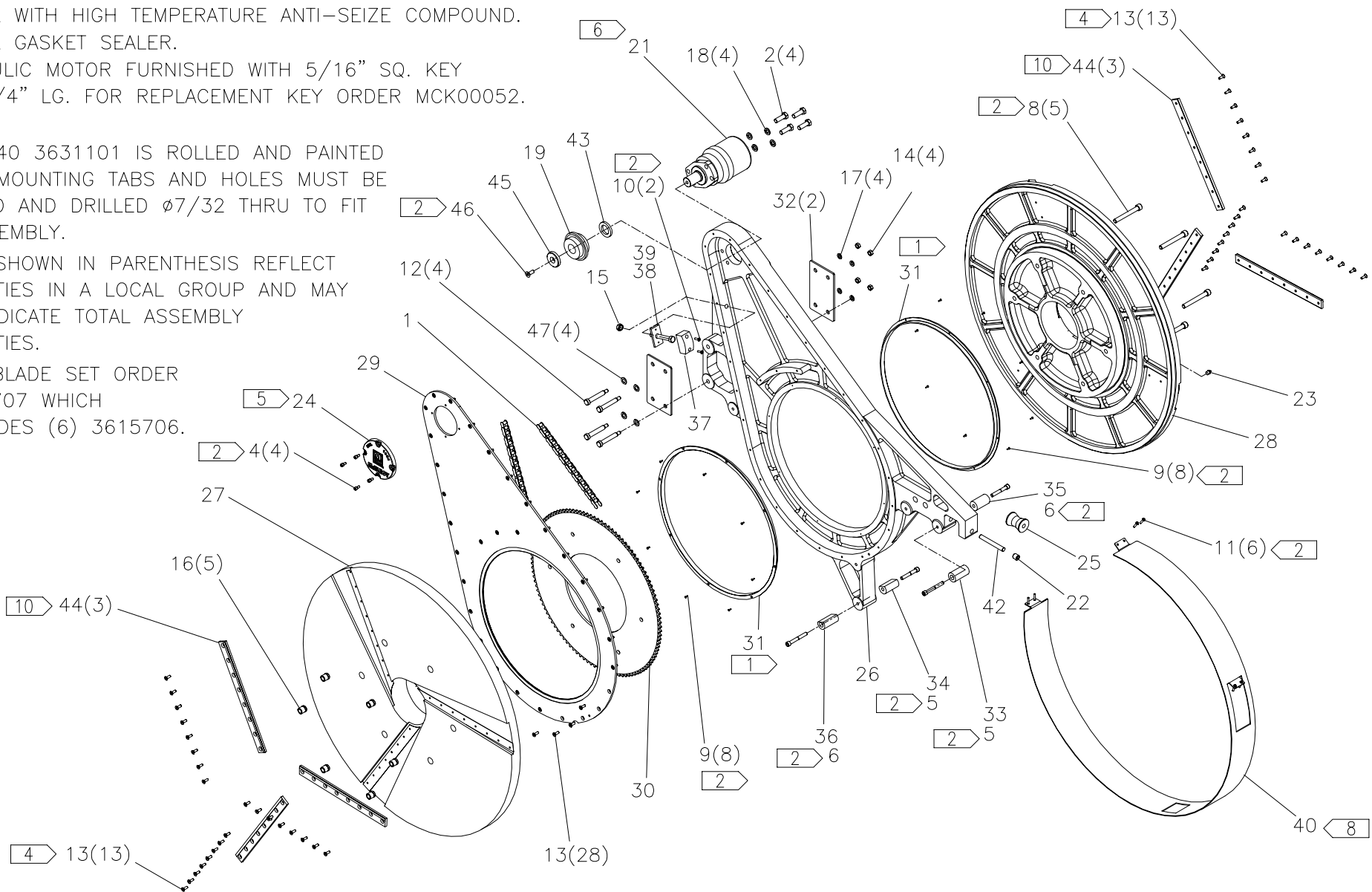

#1236A FACER ASSEMBLYPARTS LIST

ITEM	PART NO.	QTY	DESCRIPTION
	3616301		Assembly
1	A2423201	1	FACER CHAIN ASSEMBLY
2	MAB00069	4	1/2-13NC x 1-1/2 LG. HHCS
3			
4	MAC00051	4	1/4-20NC x 1/2 LG. SHCS
5	MAC00100	2	3/8-16NC x 2-1/2 LG. SHCS
6	MAC00102	2	3/8-16NC x 3" LG. SHCS
7			
8	MAC00150	6	1/2-13NC x 4" LG. SHCS
9	MAD00002	16	4-40NC x 3/8 LG. FHSCS
10	MAD00033	2	10-24NC x 3/4 LG. FHSCS
11	MAE00023	6	10-24NC x 1/2 LG. BHSCS
12	MAF00051	4	1/2 x 2-3/4 LG. SOCKET HEAD SHOULDER SCREW
13	MAH00077	79	1/4-20NC x 3/4 LG. FHSCS
14	MBA00007	4	3/8-16NC FINISHED HEX NUT
15	MBB00029	1	1/2-20NF FINISHED JAM NUT
16	MBC00017	6	1/2-13NC ALLEN LK NUT
17	MBE00007	4	3/8" REGULAR SPLIT LOCK WASHER
18	MBE00009	4	1/2" REGULAR SPLIT LOCK WASHER
19	MDF00073	1	CHAIN SPROCKET
20			
21	MEC00006	1	HYDRAULIC MOTOR
22	MFA00014	1	6MPT PLUG
23	MFJ00002	1	GREASE ZERK
24	1231102	1	#412 COVER PLATE
25	2413401	1	SUPPORT ROLLER
26	3602102	1	FACER BODY
27	3602509	1	TAPERED BLADE HOLDER
28	3602510	1	GREASE ZERK BLADE HOLDER
29	3603604	1	FACER BODY COVER ASSEMBLY
30	3603607	1	DRIVEN SPROCKET
31	3603608	2	FACER BEARING
32	3603615	2	FACER SPLICE PLATE PIVOT ARM
33	3603625	1	FACER REST BUTTON
34	3603626	1	FACER REST BUTTON
35	3603627	1	FACER REST BUTTON

#1236A FACER ASSEMBLYPARTS LIST

ITEM	PART NO.	QTY	DESCRIPTION
36	3603628	1	FACER REST BUTTON
37	3603701	1	CHAIN TENSIONER SHOE
38	3603801	1	CHAIN TENSIONER MOUNTING PLATE
39	3603901	1	CHAIN TENSIONER AJUSTABLE SCREW
40	3631101	1	FACER CHIP GUARD REPLACEMENT
41			
42	3613201	1	PIN ROLLER/ROLLER HOUSING
43	3629103	1	FACER SPROCKET SPACER
44	3615706	6	FACER BLADE
45	3629201	1	FACER SPROCKET RETAINER
46	MAD00073	1	3/8-16NC x 1" LG. FHSCS
47	MBG00002	4	1/2" TYPE 'AN' FLAT WASHER

DRAWING REVISION HISTORY LISTING

PART NO: 3616301
DESCRIPTION: #1236A FACER ASSEMBLY

<u>APPR.</u>	<u>REV</u>	<u>DATE</u>	<u>BY</u>	<u>DESCRIPTION OF REVISION</u>
B	J	4/25/95	SWB	SCANNED AND REDUCED TO 'A' SIZE FORMAT. CREATED TYPED PARTS LIST. REMOVED PIVOT ARM.
SWB	K	7/21/97	BB	CHANGED ITEM #29 FACER BODY COVER 3603605 TO FACER BODY COVER ASSEMBLY 3603604. REMOVED ITEM #20 SEAL BECAUSE IT IS PART 3603604.
SWB	L	8/22/97	SS	CHANGED ITEM #19 MDF00019 SPROCKET TO MDF00009. CHANGED ITEM #43 3614701 TO 3629101 FACER SPROCKET SPACER. ADDED ITEM #45, #46 & #47 3629201, MAD00073 & MJQ00332. REVISED SPROCKET DESIGN TO ASSIST WITH ASSEMBLY & ELIMINATE SPROCKET FRACTURE.
SWB	--	12/4/97	TLW	REVISED PARTS LIST TO DELETE (3609301) FACER CHIP GUARD ASSEMBLY AND ADD (3631101) FACER CHIP GUARD.
TLW	--	03/30/98	RLE	ITEM 19 WAS MDF00009, CHAIN SPROCKET.
TLW	--	08/26/98	AH	CORRECTED ITEM #22(MFA00034) TO (MFA00014)
SWB	M	10/27/98	DJL	FLIPPED CHAIN SPROCKET (ITEM 19) OVER TO PROVIDE BETTER CHAIN ALIGNMENT. ITEM 47 (MJQ00332 5/16 KEY X 3/4 LG.) WAS CHANGED TO MCK00041 (5/16 KEY X 1/2" LG.).
TLW	N	02/08/00	BWW	UPDATED DRAWING TO SHOW SPROCKET AND SPACER REVISION. REVISED ITEM #19 MDF00068 TO MDF00073 CHAIN SPROCKET, ITEM #43 3629101 TO 3629103 FACER SPROCKET SPACER, REMOVED ITEM #47 MCK00041 KEY AND ADDED NOTE 9.
SWB	P	06/08/01	MLM	REVISED TO ADD ITEM#47(MBG00002). ADDED TO RETRACT SHOULDER OF MAF00051 SCREW TO ALLOW ASSY. TIGHTENING.
SWB	R	07/06/01	BWW	REVISED TO REMOVE ITEMS 3 MAB00127, 7 MAC00143, AND 41 3611701. CHANGED QTY OF ITEM 15 MBB00029 FROM 3 TO 1. ITEMS CHANGED AND REMOVED WERE FOUND TO BE UNNECESSARY.
SWB	S	01/03/03	BWW	REVISED QTY OF ITEM 33 & 35 3603625 & 3603627 FROM 2 TO 1 AND ITEMS 5 & 6 MAC00100 & MAC00102 FROM 3 TO 2. PARTS MOVED TO 3602203 FACER PIVOT ARM ASSEMBLY FOR PRODUCT STRUCTURE CONSISTENCY.
SWB	T	3/19/03	RLE	REVISED NOTES TO AGREE WITH ENGINEERING STANDARDS.
LAA	U	9/3/03	ALK	REVISED ITEM #21 FROM MEC00006 DAN FOSS MOTOR TO MEC00032 PARKER MOTOR. ADDED FLAG NOTE 10 TO ITEM #21 CALLOUT.
SWB	V	04/02/04	BWW	REVISED ITEM 21 MEC00032 TO MEC00006 BECAUSE MEC00032 IS NOW BACKWARDS COMPATIBLE WITH MEC00006.
SWB	W	11/08/05	BWW	REMOVED OLD NOTE 1 FOR ATTACHING BLADES TO BOTH BLADE HOLDERS AND NOTE 3 FOR NEAR SIDE/FAR SIDE WHICH ARE NO LONGER NECESSARY. CREATED EXPLODED ISOMETRIC VIEW AND ADDED NOTE 9 AND 10 FOR CLARITY. ADDED NEW NOTE 8 AND FLAG NOTE TO DRAWING FOR FACER CHIP GUARD REPLACEMENT.
SWB	X	1/30/07	ARB	REMOVED NOTE '7', NO LONGER NEEDED AFTER CHANGES MADE TO REV 'V'.