

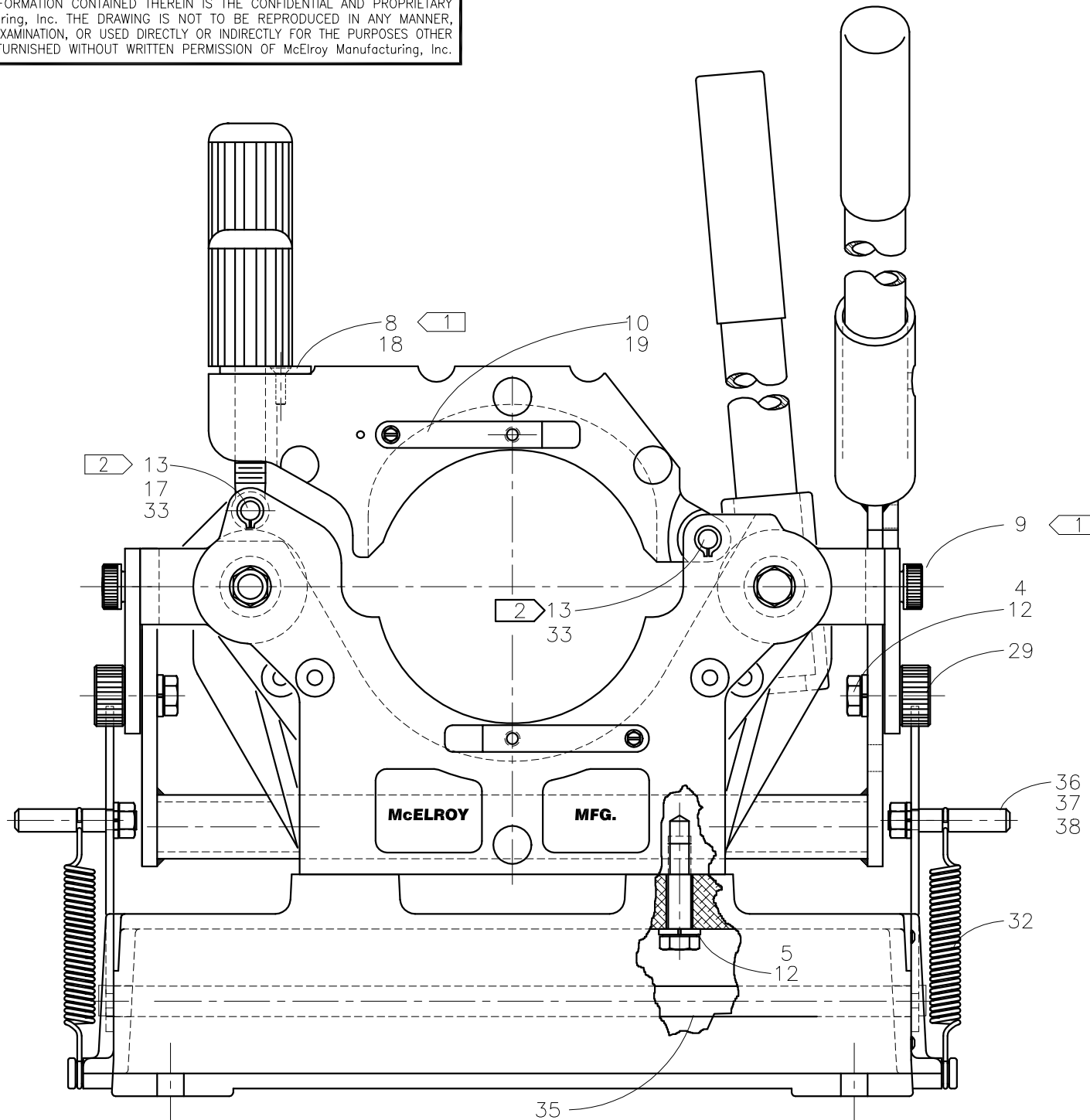

McElroy Manufacturing, Inc.
The leader by design.
Tulsa, Oklahoma U.S.A.

DRAWN: SWB	CHECK: BWP	APPRV'D: B	DATE: 5/16/95	DWG No: 420000	SHT No: 1A	REV No: P	PART No: 420001
#14 BUTT FUSION MACHINE ASSEMBLY							CAD No: 420001

NOTE: THIS DRAWING AND THE INFORMATION CONTAINED THEREIN IS THE CONFIDENTIAL AND PROPRIETARY PROPERTY OF McElroy Manufacturing, Inc. THE DRAWING IS NOT TO BE REPRODUCED IN ANY MANNER, SUBMITTED OUTSIDE PARTIES FOR EXAMINATION, OR USED DIRECTLY OR INDIRECTLY FOR THE PURPOSES OTHER THAN THOSE FOR WHICH IT WAS FURNISHED WITHOUT WRITTEN PERMISSION OF McElroy Manufacturing, Inc.





McElroy Manufacturing, Inc.
 The leader by design.
 Tulsa, Oklahoma U.S.A.

DRAWN: SWB	CHECK: BWP	APPRV'D: B	DATE: 5/16/95	DWG No: 420000	SHT No: 1B	REV No: P	PART No: 420001
#14 BUTT FUSION MACHINE ASSEMBLY							CAD No: 420001

NOTE: THIS DRAWING AND THE INFORMATION CONTAINED THEREIN IS THE CONFIDENTIAL AND PROPRIETARY PROPERTY OF McElroy Manufacturing, Inc. THE DRAWING IS NOT TO BE REPRODUCED IN ANY MANNER, SUBMITTED OUTSIDE PARTIES FOR EXAMINATION, OR USED DIRECTLY OR INDIRECTLY FOR THE PURPOSES OTHER THAN THOSE FOR WHICH IT WAS FURNISHED WITHOUT WRITTEN PERMISSION OF McElroy Manufacturing, Inc.

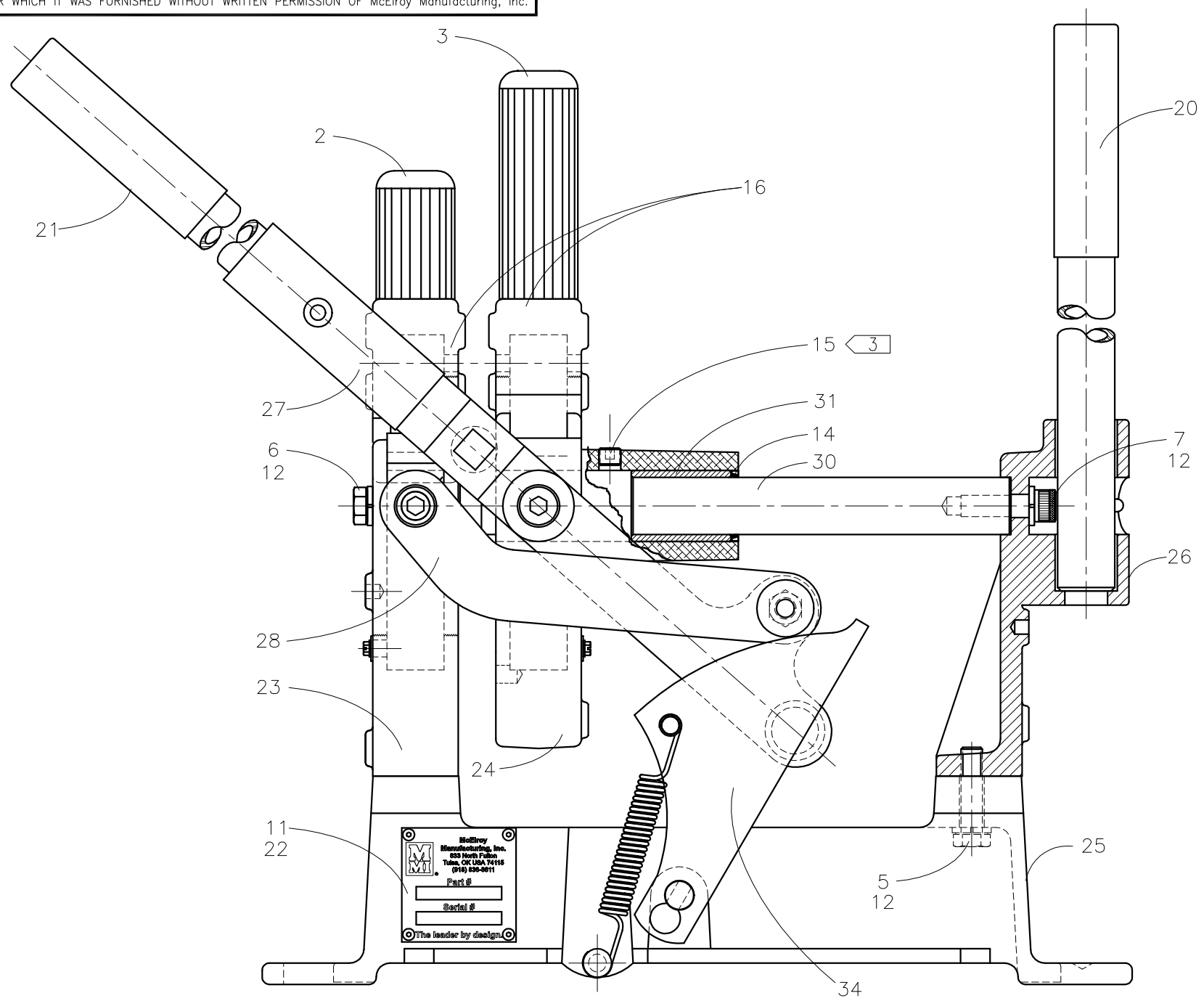

McElroy Manufacturing, Inc.
 633 North Fulton
 Tulsa, OK USA 74116
 (918) 436-8011
 Part #
 Serial #
 The leader by design

#14 BUTT FUSION MACHINE ASSEMBLYParts List

ITEM	PART NO.	QTY.	DESCRIPTION
	420001		ASSEMBLY
1	A214201	1	BUTT FUSION SCREW / DRIVER KIT (NOT SHOWN)
2	A829001	1	SHORT CLAMP KNOB ASSEMBLY
3	A829101	1	LONG CLAMP KNOB ASSEMBLY
4	MAB00064	2	3/8-16NC X 1LG HHCS
5	MAB00066	4	3/8-16NC X 1-1/2LG HHCS
6	MAB00068	2	3/8-16NC X 2LG HHCS
7	MAC00094	2	3/8-16NC X 1LG SHCS
8	MAH00074	4	#8-32NC X 3/8LG FHSCS SS
9	MAF00041	4	1/2DIA X 1/2LG SOCKET SHOULDER SCREW
10	MAH00036	4	#6-32NC X 3/8LG HEX WASHER HEAD TYP 'F' STL PL
11	MAH00093	4	#4-40NC X 3/16LG LOCK SCREW
12	MBE00007	10	3/8 REG SPLIT LOCK WASHER STL PL
13	MCB00022	4	EXT SNAP RING
14	MDL00051	8	SEAL
15	MFA00001	2	1MPT PLUG
16	401202	2	UPPER JAW
17	401601	2	EYEBOLT
18	402001	2	CLAMP PAD
19	402301	4	INSERT KEEPER SPRING PIN ASSY
20	402801	1	24" LONG LEVER ASSY
21	402802	1	18" LONG LEVER ASSY
22	PL1-420001	1	NAMEPLATE
23	420502	1	14 LOWER FIXED JAW
24	420603	1	14 LOWER MOVABLE JAW
25	420702	1	BASE
26	420802	1	14 TAILSTOCK
27	420901	1	14 YOKE
28	421001	2	14 LINK
29	421201	2	14 YOKE LOCK PIVOT
30	421301	2	14 GUIDE ROD
31	421701	4	GUIDE ROD BUSHING
32	421801	2	PIVOT LOCKING SPRING
33	426401	4	14 JAW PIVOT PIN
34	431601	2	#14 Pit Bull™ LOCK CAM
35	431401	1	#14 Pit Bull™ LOCK CAM SHAFT
36	433501	2	#14 Pit Bull™ SPRING POST
37	MBE00006	2	5/16 LOCK WASHER
38	MBA00006	2	5/16-18NC FINISH HEX NUT STL PL

NOTES:

1. INSTALL WITH #242 LOCTITE
2. INSTALL WITH SNAP RING ON THE OUTSIDE OF JAWS.
3. FILL WITH 10W-40 SAE OIL TO LUBRICATE GUIDE ROD BUSHINGS.

Replacement Assembly Part Numbers

<u>PART NO.</u>	<u>QTY.</u>	<u>DESCRIPTION</u>
A422101		14BM Lower Fixed Jaw Assembly, including:
MAH00036	1ea.	#6-32NCX3/8LG HWH TC SCR
MCB00022	2ea.	Ext. Snap Ring
402301	1 ea.	Insert Keeper Spring Pin Assembly
420502	1ea.	14 Lower Fixed Jaw
426401	2ea.	14 Jaw Pivot Pin
A412002		14BM Upper Jaw Assembly, including:
MAH00074	2ea.	#8-32NCX3/8LG FHSCS SS
MAH00036	1ea.	#6-32NCX3/8LG HWH TC SCR
MCB00022	1ea.	Ext. Snap Ring
401202	1 ea.	Upper Jaw
402001	1 ea.	Clamp Pad
402301	1ea.	Insert Keeper Spring Pin Assembly
426401	1ea.	14 Jaw Pivot Pin
A422201		14BM Lower Movable Jaw Assembly, including:
MAH00036	1ea.	#6-32NCX3/8LG HWH TC SCR
MCB00022	2ea.	Ext. Snap Ring
MDL00051	8ea.	Rod Wiper
MFA00001	2ea.	1MPT Plug
402301	1 ea.	Insert Keeper Spring Pin Assembly
420603	1ea.	14 Lower Movable Jaw
421701	4 ea.	Guide Rod Bushing
426401	2ea.	14 Jaw Pivot Pin
A829001		Short Clamp Knob Assembly, including:
403101	1ea.	Bearing Assembly
403201	1 ea.	Snap Ring
828901	1ea.	Short Clamp Knob
A829101		Long Clamp Knob Assembly, including:
403101	1 ea.	Bearing Assembly
403201	1 ea.	Snap Ring
828902	1ea.	Long Clamp Knob
A422401		14BM Upper/Lower Fixed Jaw Assembly, including:
A412002	1 ea.	14BM Upper Jaw Assembly
A422101	1 ea.	14BM Lower Fixed Jaw Assembly
A829001	1 ea.	Short Clamp Knob Assembly
401601	1ea.	Eyebolt
A422301		14BM Upper/Lower Movable Jaw Assembly, including:
A412002	1 ea.	14BM Upper Jaw Assembly
A422201	1 ea.	14BM Lower Movable Jaw Assembly
A829101	1ea.	Long Clamp Knob Assembly
401601	1 ea.	Eyebolt
A425102		14BM Eyebolt Kit, including:
MCB00022	1ea.	Ext. Snap Ring
401601	1 ea.	Eyebolt
426401	1ea.	14 Jaw Pivot Pin

A426401		14BM Pivot Pin Kit, Including:
426401	4 ea.	14 Jaw Pivot Pin
MCB00022	4 ea.	Ext. Snap Ring
A430109		#14 Pit Bull™ LOCK CAM Kit, Including:
431601	2 ea.	#14 Pit Bull™ LOCK CAM
431401	1 ea.	#14 Pit Bull™ LOCK CAM SHAFT
433501	2 ea.	#14 Pit Bull™ SPRING POST
MBE00006	2 ea.	5/16 LOCK WASHER
MBA00006	2 ea.	5/16-18NC FINISH HEX NUT STL PL
421801	2 ea.	Pivot locking spring

DRAWING REVISION HISTORY LISTING

PART NO: 420001

DESCRIPTION: #14 BUTT FUSION UNIT ASSEMBLY (FRONT VIEW)

<u>APPR.</u>	<u>REV</u>	<u>DATE</u>	<u>BY</u>	<u>DESCRIPTION OF REVISION</u>
B	J	5/16/95	SWB	Scanned & reduced to 'A' size format. Moved side view to sheet 2.
B	K	3/25/97	SS	PUT 4200S01.DWG & 4200S02.DWG FILES IN ONE 420001.DWG
TLW	--	01/16/98	RLE	ADDED ITEM 44, A214201 SCR/DRIVER KIT, & ADDED NOTE 4.
TLW	L	04/24/98	RLE	UPDATED DRAWING TO SHOW CURRENT STYLE OF CLAMP KNOBS (828901 & 828902), YOKE WELDMENT (420901) & LINK (421001).
SWB	M	02/15/99	AH	REDRAWN FROM SCAN FORMAT. RENUMBERED PARTS LIST. DELETED PART NUMBERS (828901), (828902), (403101), (403201), (MJM00006) AND REPLACED THEM WITH ITEMS #2(A829001) & #3(A829101) SHORT & LONG CLAMP KNOB ASSEMBLYS. DELETED PART NUMBERS (420702) & (421603), AND REPLACED THEM WITH ITEM #25(420703) BASE WELDMENT. REVISED ITEM #10(MAH00036) QTY 8 TO QTY 4.
TLW	-	05/12/99	LBK	ADDED REPLACEMENT ASSEMBLY PART KIT.
SWB	N	09/29/00	DWK	CHANGED ITEM #8 FROM (MAD00022) TO (MAH00074) FOR A 3/8 LG SS SCREW INSTEAD OF 1/2 LG. ALSO MADE SAME CHANGE TO A412002 UNDER REPLACEMENT ASSEMBLY PARTS LIST. REMOVED FLAG 1 FROM ITEM 4, 5, 6 & 7. SCREWS WITH LOCK WASHERS DO NOT NEED LOCTITE. ADDED FLAG 1 TO ITEM 8. THESE CHANGES MADE TO MATCH AS BUILT CONDITIONS.
TMT	P	10/16/00	MLM	ADDED ITEMS 34-38, ITEM 25 WAS 420703 CHANGED TO 420702 BASE. ADDED A430109 LOCK CAM KIT.
TLW	--	12/07/00	RLE	CORRECTED ITEM #7 FROM MAH00094 TO MAC00094.
TLW	-	01/04/01	BWW	REVISED TO CHANGE ITEM # 22 FROM 410904 TO PL1-420001 TO COMPLY WITH NEW NAME PLATE STANDARD.