

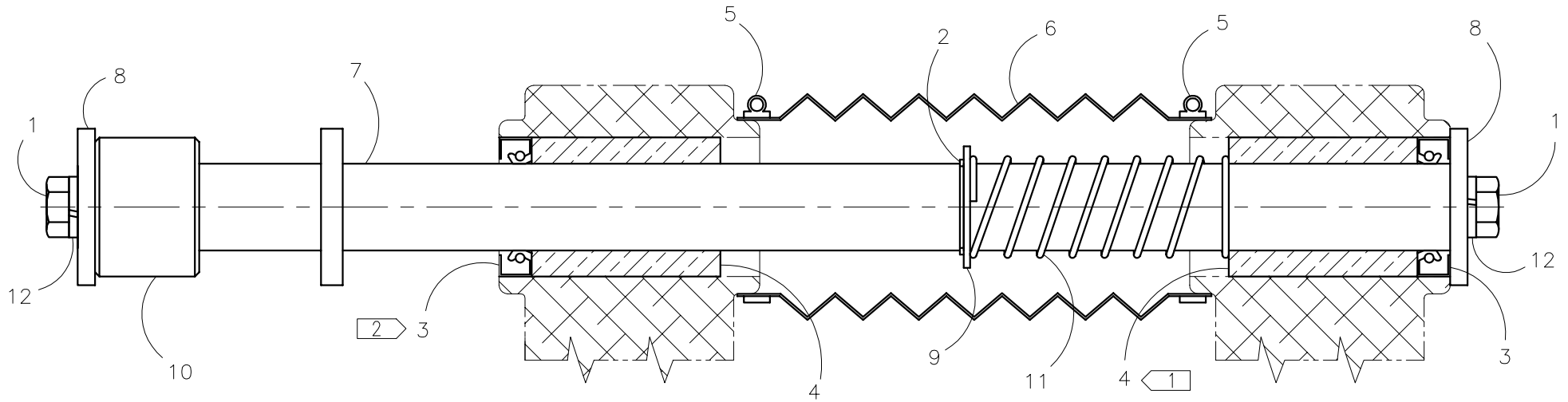

McElroy Manufacturing, Inc.
The leader by design.
Tulsa, Oklahoma U.S.A.

DRAWN: TLW	CHECK: TMT	APPRV'D: SWB	DATE: 1/17/97	DWG No: 1824000	SHT No: 1	REV No: A	PART No: 1824001
#412/#618 FACER PIVOT SHAFT ASSEMBLY							CAD No: 1824001

NOTE: THIS DRAWING AND THE INFORMATION CONTAINED THEREIN IS THE CONFIDENTIAL AND PROPRIETARY PROPERTY OF McElroy Manufacturing, Inc. THE DRAWING IS NOT TO BE REPRODUCED IN ANY MANNER, SUBMITTED OUTSIDE PARTIES FOR EXAMINATION, OR USED DIRECTLY OR INDIRECTLY FOR THE PURPOSES OTHER THAN THOSE FOR WHICH IT WAS FURNISHED WITHOUT WRITTEN PERMISSION OF McElroy Manufacturing, Inc.



#412/#618 FACER PIVOT SHAFT ASSEMBLYParts List

ITEM	PART NO.	QTY.	DESCRIPTION
	1824001	1	ASSEMBLY
1	MAB00103	2	1/2-13NC X 1 LG HHCS
2	MCB00008	1	SNAP RING
3	MDL00046	2	SEAL
4	MDM00036	2	BALL BUSHING
5	MFD00049	2	HOSE CLAMP
6	836401	1	ROD BOOT
7	1805601	1	FACER PIVOT SHAFT
8	1805701	2	WASHER
9	1805702	1	WASHER
10	1812202	1	SPACER
11	1872601	1	FACER PIVOT SHAFT SPRING
12	MBE00009	2	1/2 REGULAR SPLIT LOCK WASHER

NOTES:

1. INSTALL WITH LOCTITE PRIMER T AND LOCTITE 680.
CAUTION: APPLY THIN LAYER OF LOCTITE TO O.D. OF BEARING. EXCESSIVE AMOUNT MAY BLEED INTO BALL CAVITY & LOCK-UP BEARINGS.
ALLOW 30 MIN. TO CURE.
2. INSTALL SEAL AS SHOWN TO ACT AS WIPER.

DRAWING REVISION HISTORY LISTING

PART NO: 1824001
DESCRIPTION: #412/#618 FACER PIVOT SHAFT ASSEMBLY

<u>APPR.</u>	<u>REV</u>	<u>DATE</u>	<u>BY</u>	<u>DESCRIPTION OF REVISION</u>
SWB	--	01/21/03	BWW	ADDED CAUTION NOTE FOR APPLICATION OF LOCTITE TO LINEAR BEARINGS.
SWB	A	01/04/05	BWW	REVISED ITEM 11 FROM 1815701 TO 1872601 TO INCREASE RETURN FORCE ON 18" FACER.