

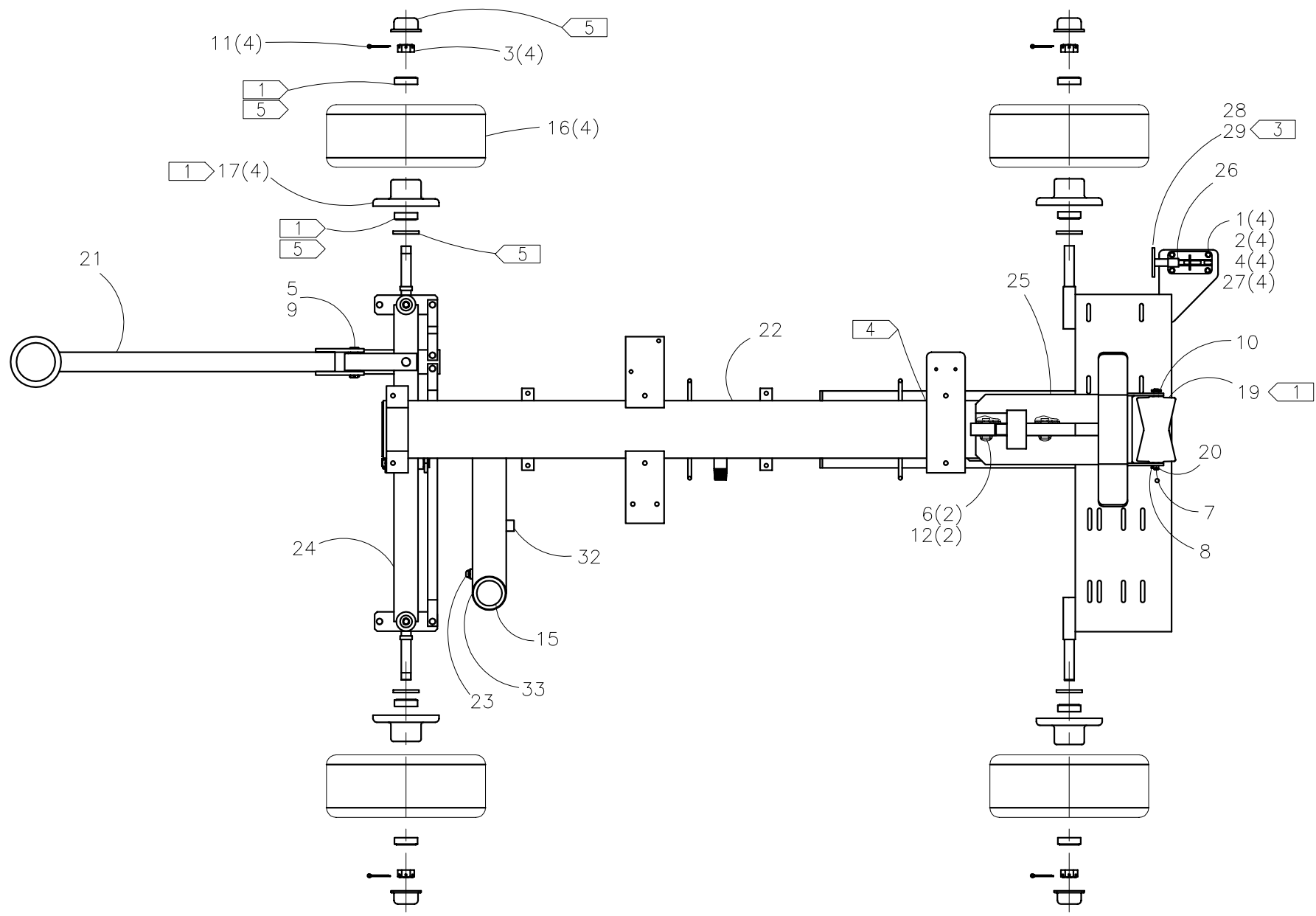

McElroy Manufacturing, Inc.
 The leader by design.
 Tulsa, Oklahoma U.S.A.

DRAWN: TLW	CHECK: TMT	APPRV'D: SWB	DATE: 11/18/96	DWG No.: 1822100	SHT No.: 1	REV No.: H	PART No.: 1822101
#412/#618 GAS/ELECTRIC ROLLING CHASSIS ASSEMBLY							CAD No.: 1822101

NOTE: THIS DRAWING AND THE INFORMATION CONTAINED THEREIN IS THE CONFIDENTIAL AND PROPRIETARY PROPERTY OF McElroy Manufacturing, Inc. THE DRAWING IS NOT TO BE REPRODUCED IN ANY MANNER, SUBMITTED OUTSIDE PARTIES FOR EXAMINATION, OR USED DIRECTLY OR INDIRECTLY FOR THE PURPOSES OTHER THAN THOSE FOR WHICH IT WAS FURNISHED WITHOUT WRITTEN PERMISSION OF McElroy Manufacturing, Inc.



#412/#618 GAS/ELECTRIC ROLLING CHASSIS ASSEMBLYParts List

ITEM	PART NO.	QTY.	DESCRIPTION
	1822101		ASSEMBLY
1	MAB00033	4	5/16"-18NC X 1 LG HHCS
2	MBA00006	4	5/16"-18NC FINISHED HEX NUT
3	MBD00041	4	1-14UNS AXLE NUT
4	MBE00006	4	5/16" LOCKWASHER
5	MCF00004	1	3/4" DIA. X 2 27/32 GRIP CLEVIS PIN
6	MCF00016	2	3/4" DIA. X 2 11/32 GRIP CLEVIS PIN
7	MCG00024	1	1/8" DIA. X 1 1/2 LG ROLL PIN
8	MCG00028	1	1/4" DIA. X 1/2 LG ROLL PIN
9	MCH00001	1	1/8" DIA. X 1 LG COTTER PIN
10	MCH00004	1	1/8" DIA. X 1 1/4 LG COTTER PIN
11	MCH00005	4	1/8" DIA. X 2 LG COTTER PIN
12	MCH00021	2	3/4" DIA. X 2 11/16 LG HAIR PIN
13			
14			
15	MFK00001	1	FILLER CAP
16	MIA00005	4	WHEEL & TIRE ASSY
17	MIB00001	4	HUB W/ BEARINGS, SEAL, CAP & LUG NUTS
18			
19	802105	1	PIPE LIFT ROLLER
20	812802	1	PIPE LIFT ROLLER SHAFT
21	1209402	1	TOW BAR
22	1242301	1	#412/#618 CHASSIS WELDMENT
23	MFJ00013	1	OIL EYE LENSE & O-RING
24	1822001	1	FRONT AXLE ASSEMBLY
25	1855401	1	PIPE LIFT ARM WELDMENT
26	MJA00006	1	TOGGLE CLAMP
27	MBF00006	4	5/16 TYPE 'A' WIDE FLAT WASHER
28	1857001	1	BRAKE PAD
29	MAD00073	1	3/8-16NC X 1"LG FHSCS
30			
31			
32	MFA00014	1	6MPT PLUG
33	8163106	1	HYDRAULIC OIL SPECIFICATION LABEL

NOTES:

1. PACK WHEEL HUB AND BEARINGS AND FILL PIPE LIFT ROLLER WITH EP GREASE.
- 2.
3. INSTALL WITH HIGH STRENGTH THREAD LOCKING COMPOUND.
4. ATTACH NAMEPLATE AT FINAL ASSEMBLY USING (4) DRIVE SCREWS.
5. ITEM 17 MIB00001 INCLUDES: (1) MDL00120 SEAL, (2) MDM00189 TAPERED ROLLER BEARING CONES, AND (1) MIB00011 GREASE CAP. THESE PARTS MAY BE ORDERED SEPARATELY.

DRAWING REVISION HISTORY LISTING

PART NO: 1822101

DESCRIPTION: #412/#618 GAS/ELECTRIC ROLLING CHASSIS ASSEMBLY

<u>APPR.</u>	<u>REV</u>	<u>DATE</u>	<u>BY</u>	<u>DESCRIPTION OF REVISION</u>
TMT	A	5/23/97	AH	CHANGED ITEM #26 (3612603) TO MJA00006, ADDED ITEM #28 (1857001), ADDED ITEM #29 (MAD00073), ADDED NOTE #3
TLW	B	02/23/98	RLE	ADDED ITEM 30, MCK00008 & ITEM 31, 841201
SWB	C	11/6/98	DJL	REMOVED ITEM 30, MCK00008 GRIP BLIND RIVET USED FOR MOUNTING NAME PLATE. NAME PLATE IS BEING SUPPLIED WITH ADHESIVE BACKING.
LAA	D	2/19/02	RLE	REMOVED ITEM #31 841201 NAMEPLATE. ITEM TO BE ADDED AT FINAL ASSEMBLY & ADDED ITEM #32 MFA00014.
SWB	E	03/12/03	BWW	ADDED NOTE 4 FOR ATTACHMENT OF NAMEPLATE AT FINAL ASSEMBLY.
MLM	F	04/16/03	BWW	ADDED ITEM 23 MFJ00013 QTY 1 WHICH IS NOW PURCHASED SEPARATELY, AND REMOVED NOTE 2.
SWB	G	06/17/03	BWW	REVISED TO REMOVE ITEMS: 13-MDL00120, 14-MDM00189, AND 18-MIB00011. REVISED DESCRIPTION OF ITEM 17 (HUB) TO INCLUDE PARTS INCLUDED WITH THE HUB. ADDED NOTE 5 FOR PURCHASING SEPARATELY PARTS THAT ARE CONTAINED WITHIN HUB. UPDATED NOTE 1 TO INCLUDE PACKING BEARING AND NOTE 3 TO USE STANDARD NOTE SPECIFICATION.
SWB	H	10/25/04	MLM	REVISED TO ADD ITEM-33 (HYDRAULIC OIL SPECIFICATION LABEL-8163106)