

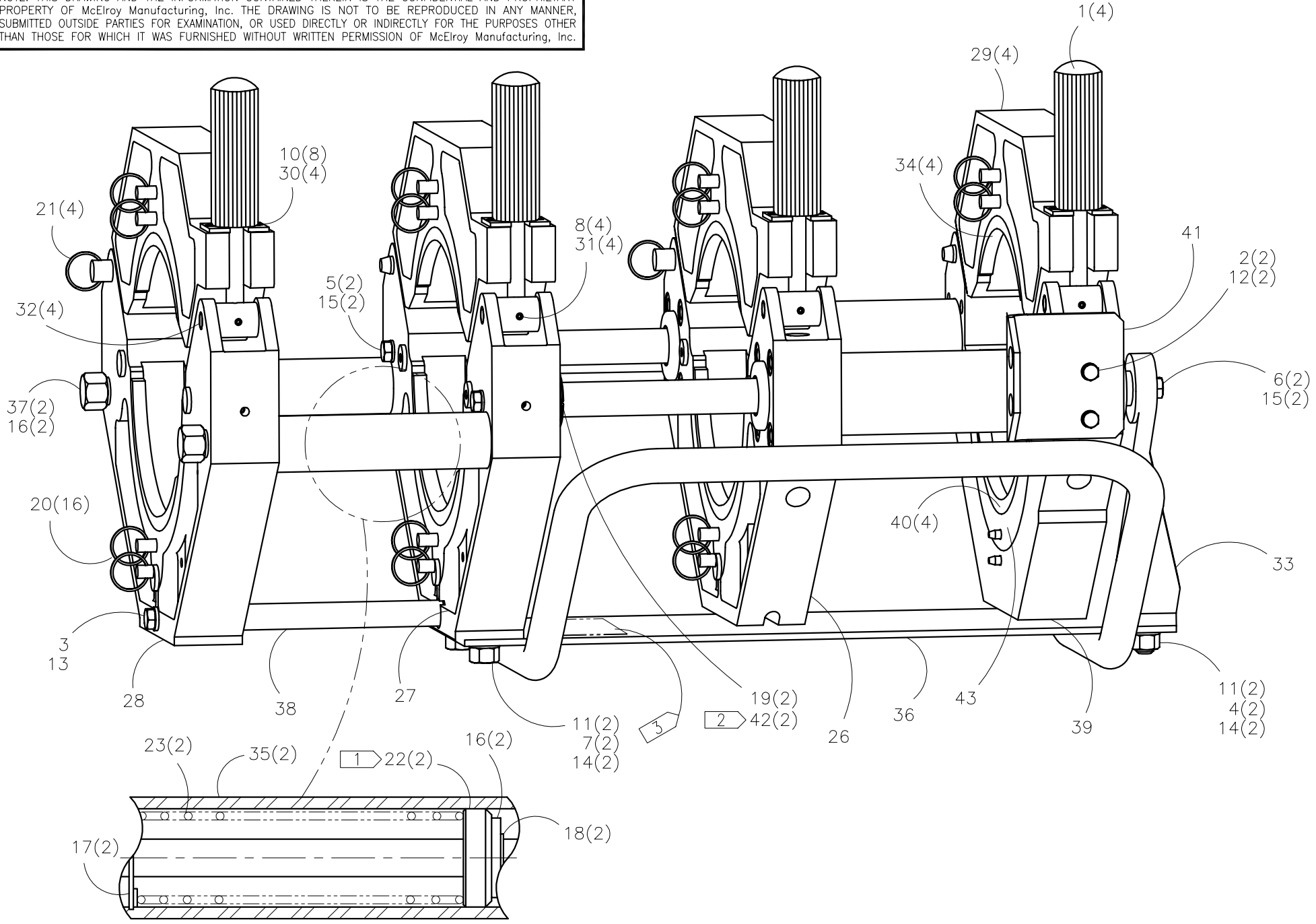

**McElroy Manufacturing, Inc.**  
 The leader by design.  
 Tulsa, Oklahoma U.S.A.

DRAWN: TLW	CHECK: SWB	APPRV'D: B	DATE: 2/11/97	DWG No: 850500	SHT No: 1	REV No: D	PART No: 850501
Mc28 Pit Bull DIPS CARRIAGE SUB ASSEMBLY							CAD No: 850501

NOTE: THIS DRAWING AND THE INFORMATION CONTAINED THEREIN IS THE CONFIDENTIAL AND PROPRIETARY PROPERTY OF McElroy Manufacturing, Inc. THE DRAWING IS NOT TO BE REPRODUCED IN ANY MANNER, SUBMITTED OUTSIDE PARTIES FOR EXAMINATION, OR USED DIRECTLY OR INDIRECTLY FOR THE PURPOSES OTHER THAN THOSE FOR WHICH IT WAS FURNISHED WITHOUT WRITTEN PERMISSION OF McElroy Manufacturing, Inc.



**Mc28 Pit Bull™ DIPS CARRIAGE SUB ASSEMBLY**Parts List

ITEM	PART NO.	QTY.	DESCRIPTION
	<b>850501</b>		<b>ASSEMBLY</b>
1	A829101	4	LONG CLAMP KNOB ASSEMBLY
2	MAA00003	2	1/4-20NC HHCS X 1 3/4 LG
3	MAA00070	1	3/8-16NC HHCS X 2 1/2 LG
4	MAA00127	2	1/2-13NC HHCS X 1 3/4 LG
5	MAB00076	2	3/8-16NC HHCS X 2 1/4 LG.
6	MAB00077	2	3/8-16NC HHCS X 1 LG
7	MAC00147	2	1/2-13NC SHCS X 3 LG
8	MAG00002	4	#10-24NC X 3/8"LG. SHSS
9			
10	MAN00001	8	#10-24NC X 3/8" LG FHSCS SS
11	MBA00009	4	1/2-13NC HEX NUT
12	MBE00005	2	1/4 LOCKWASHER
13	MBE00007	1	3/8 LOCK WASHER
14	MBE00009	4	1/2 SPLIT LOCK WASHER
15	MBG00001	4	3/8 AN WASHER
16	MBG00017	4	WASHER
17	MCA00027	2	INT SNAP RING
18	MCB00001	2	SNAP RING
19	MCB00050	2	SNAP RING
20	MCE00002	16	1/4"DIA X 2.00" GRIP DETENT PIN
21	MCE00006	4	1/2"DIA X 2.00" GRIP DETENT PIN
22	MDM00196	2	THRUST BEARING
23	MJE00021	2	SPRING
24			
25			
26	848508	1	Mc28 PitBull DIPS LOWER INNER HYDRAULIC JAW
27	848509	1	Mc28 PitBull DIPS LOWER INNER FIXED JAW
28	848510	1	Mc28 PitBull DIPS LOWER OUTER FIXED JAW
29	848602	4	DIPS UPPER JAW
30	801701	4	PAD-CLAMP
31	803901	4	EYEBOLT
32	808501	4	CLAMP PIVOT PIN
33	811803	1	GUIDE ROD SUPPORT PLATE
34	807202	4	8" IPS/DIPS UPPER MASTER INSERT
35	843601	2	SPACER TUBE
36	843801	1	CARRIAGE SKID
37	843902	2	OUTER FIXED JAW TIE BOLT
38	844601	1	BRACE BAR
39	844803	1	Mc28 PitBull LOWER OUTER MOVEABLE JAW
40	807201	4	8" IPS/DIPS MASTER INSERT INVESTMENT CASTING

**Mc28 Pit Bull™ DIPS CARRIAGE SUB ASSEMBLY**Parts List

ITEM	PART NO.	QTY.	DESCRIPTION
41	848201	1	CARRIAGE HOSE BRACKET
42	848301	2	FACER SPACER RING SET
43	844903	1	8" DIPS MASTER INSERT

**NOTES:**

1. INSTALL ITEM #22(MDM00196) THRUST BEARING WITH LARGE CHAMFER SIDE OPPOSITE ITEM #23(MJE00021) SPRING.
2. ITEM #42 FACER SPACER RING SET CONSISTS OF 2 HALVES.
3. ATTACH NAMEPLATE AT FINAL ASSEMBLY WITH (4) DRIVE SCREWS USING EXISTING HOLES.

## DRAWING REVISION HISTORY LISTING

**PART NO:** 850501

**DESCRIPTION:** Mc28 Pit Bull DIPS CARRIAGE SUB ASSEMBLY

<u>APPR.</u>	<u>REV</u>	<u>DATE</u>	<u>BY</u>	<u>DESCRIPTION OF REVISION</u>
SWB	A	11/25/97	DJL	REMOVED ITEM 24 MJM00006 (KEENSERT) AND ADDED IT TO LOWER INNER FIXED JAW 801018 FOR SERVICE PART.
SWB	B	11/6/98	DJL	REMOVED ITEM 9, MAH00093 STICK SCREWS FOR MOUNTING NAME PLATE. NAME PLATE IS BEING SUPPLIED WITH ADHESIVE BACKING.
TLW	C	3/7/00	BWW	ADDED NOTE 2 TO CLARIFY QUANTITY OF ITEM #42.
SWB	D	03/12/03	BWW	REVISED TO REMOVE ITEM 25 410904 DUE TO TABULATION OF NAMEPLATES. ADDED NOTE 3 FOR ATTACHMENT OF NAMEPLATE AT FINAL ASSEMBLY.