

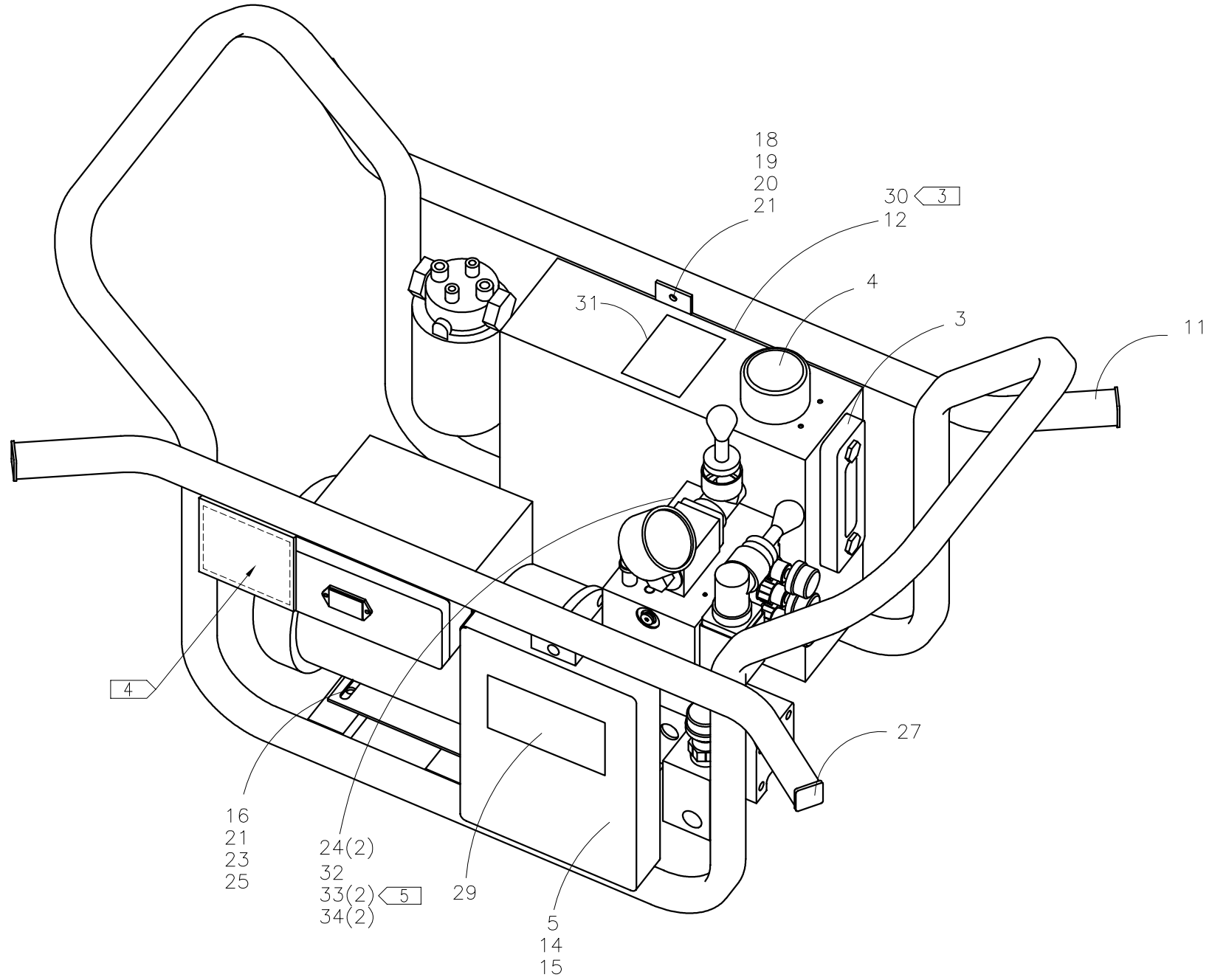

McElroy Manufacturing, Inc.
 The leader by design.
 Tulsa, Oklahoma U.S.A.

DRAWN: DWP/AH	CHECK: SWB	APPRV'D: B	DATE: 5/24/96	DWG No.: 847300	SHT No.: 1	REV No.: G	PART No.: 847301
Mc28 Pit Bull POWER UNIT SUB ASSEMBLY							CAD No.: 847301

NOTE: THIS DRAWING AND THE INFORMATION CONTAINED THEREIN IS THE CONFIDENTIAL AND PROPRIETARY PROPERTY OF McElroy Manufacturing, Inc. THE DRAWING IS NOT TO BE REPRODUCED IN ANY MANNER, SUBMITTED OUTSIDE PARTIES FOR EXAMINATION, OR USED DIRECTLY OR INDIRECTLY FOR THE PURPOSES OTHER THAN THOSE FOR WHICH IT WAS FURNISHED WITHOUT WRITTEN PERMISSION OF McElroy Manufacturing, Inc.



Mc 28 Pit Bull POWER UNIT ASSEMBLYParts List

ITEM	PART NO.	QTY.	DESCRIPTION
	847301		ASSEMBLY
1			
2			
3	MEE00014	1	SIGHT GAUGE W/THERMOMETER
4	MFK00001	1	FILLER CAP
5	MJQ00259	1	STANDARD 9" X 6" LITERATURE COMPARTMENT
6			
7			
8			
9			
10			
11	847101	1	SKID FRAME WELDMENT
12	847201	1	HYDRAULIC RESERVOIR WELDMENT
13	MAB00048	2	5/16-18NC X 5-1/2"LG HHCS
14	MBH00043	4	1/4-20NC ACORN NUT
15	MAH00147	4	1/4-20NC BHCS X 1/2 LG
16	MAB00033	4	5/16-18NC HHCS X 1 LG
17			
18	MAB00006	1	1/4-20NC HHCS X 1 1/2 LG
19	MAB00003	2	1/4-20NC HHCS X 3/4 LG
20	MBA00005	3	1/4-20NC HEX NUT
21	MBA00006	4	5/16-18NC HEX NUT
22	MBE00005	3	1/4 LOCK WASHER
23	MBE00006	4	5/16 LOCK WASHER
24	MBE00007	2	3/8 LOCK WASHER
25	MBF00006	4	5/16 FLAT WASHER
26			
27	MJQ00299	4	1 X 1 END PLUG
28			
29	816342	1	SAFETY INSTRUCTION MANUAL LABEL
30	816367	1	Pit Bull LOGO LABEL
31	8163106	1	HYDRAULIC OIL SPECIFICATION LABEL
32	849301	1	HPU MANIFOLD MOUNTING ADAPTER
33	MAN00038	2	3/8-16NC X 1 LG FHSCS SS
34	MAN00039	2	3/8-16NC X 1-1/2 LG FHSCS SS

NOTES:

1. See #842401 Mc28 Pit Bull power unit hydraulic schematic for plumbing components & hoses.
2. See standard #28 elec. motor/box sub assembly for electrical components.
3. Center label on tank.

Mc 28 Pit Bull POWER UNIT ASSEMBLYParts List

ITEM	PART NO.	QTY.	DESCRIPTION
			4. Use nameplate as template to drill (4) 1/8" dia. Holes. Attach specific voltage nameplate here using 1/8" pop rivets at final assembly.
			5. Apply medium strength thread locking compound.

DRAWING REVISION HISTORY LISTING

PART NO: 847301
DESCRIPTION: Mc28 Pit Bull POWER UNIT SUB ASSEMBLY

<u>APPR.</u>	<u>REV</u>	<u>DATE</u>	<u>BY</u>	<u>DESCRIPTION OF REVISION</u>
SWB	A	11/06/96	SS	REMOVE NOTES FROM DRAWING. REMOVE ITEM #10 FROM DRAWING. REMOVE FROM BOM ITEM #1 MDJ00005, ITEM #2 MEA00002, ITEM #7 816330, ITEM #8 816331, ITEM #9 842401, ITEM #10 846901, ITEM #29 A842401, AND ITEM #30 A842403. CHANGE ITEM #13 MAA00049 TO MAA00048. ADD NOTES 1 & 2 TO BOM.
SWB	B	10/21/97	RLE	REPLACED ITEM #26 (MJQ00309, PIT BULL STICKER) WITH ITEM #30 (816367, PITBULL LOGO LABEL) & MOVED TO OPPOSITE SIDE OF HPU. ADDED ITEM #29 (816342, SAFETY INSTRUCTION MANUAL LABEL) TO MANUAL BOX.
SWB	--	01/24/98	RLE	CORRECTED ITEM 28, WAS 821001 NAMEPLATE.
SWB	C	09/13/01	BWW	REMOVED ITEM 28; 841201 NAMEPLATE DUE TO TABULATION OF ALL NAMEPLATES.
SWB	D	10/24/01	BWW	ADDED NOTE ON DRAWING TO SHOW S/N TAG LOCATION.
SWB	E	03/12/03	BWW	ADDED NOTE 4 FOR ATTACHMENT OF NAMEPLATE AT FINAL ASSEMBLY.
SWB	F	04/07/05	JAB	ADDED ITEM 31 8163106 HYDRAULIC OIL SPECIFICATION LABEL.
SPA	G	07/27/05	JAB	REVISED TO ADD ITEM #32 (849301), #33 (MAN00038) & #34 (MAN00039), AND REMOVE ITEM #17 (MAB00064). ADDED NOTE 5 FOR PROPER MOUNTING OF MANIFOLD BLOCK. ALL CHANGES WERE MADE DUE TO SUPPLIER CHANGE OF PUMP ADAPTER (MEA00002).