



McElroy Manufacturing, Inc.
The leader by design.
Tulsa, Oklahoma U.S.A.

DRAWN: TLW

CHECK: BWP

APPRV'D: B

DATE: 5/19/95

SHT No: 1

REV No: D

PART No: 812501

2"-8" PIPE STAND ASSEMBLY

NOTE: THIS DRAWING AND THE INFORMATION CONTAINED THEREIN IS THE CONFIDENTIAL AND PROPRIETARY PROPERTY OF McElroy Manufacturing, Inc. THE DRAWING IS NOT TO BE REPRODUCED IN ANY MANNER, SUBMITTED OUTSIDE PARTIES FOR EXAMINATION, OR USED DIRECTLY OR INDIRECTLY FOR THE PURPOSES OTHER THAN THOSE FOR WHICH IT WAS FURNISHED WITHOUT WRITTEN PERMISSION OF McElroy Manufacturing, Inc.

NOTES:

1. ITEMS SHOWN IN PARENTHESIS REFLECT QUANTITIES IN A LOCAL GROUP AND MAY NOT INDICATE TOTAL ASSEMBLY QUANTITIES.

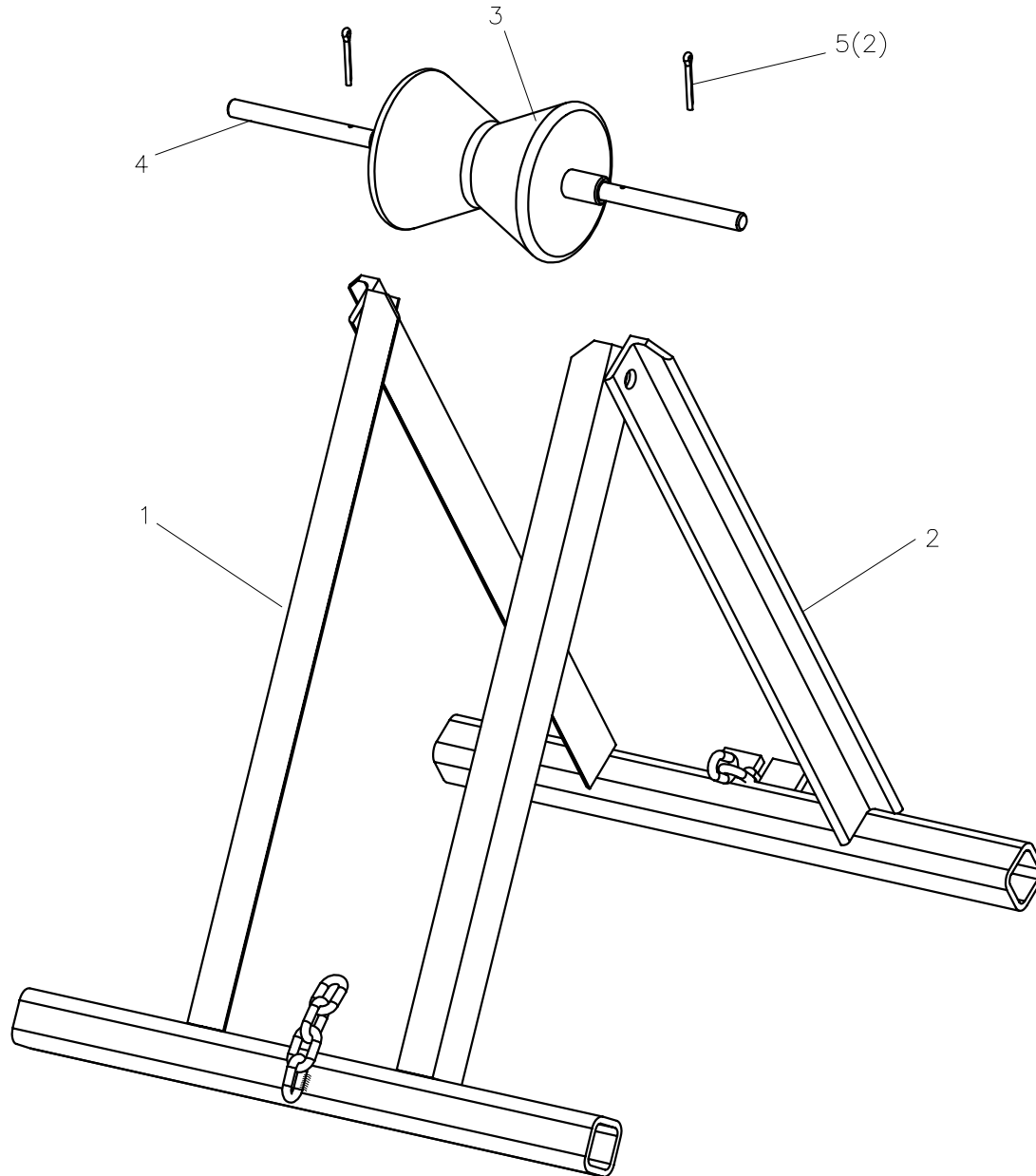

2" - 8" PIPE STAND ASSEMBLYPARTS LIST

ITEM	PART NO.	QTY	DESCRIPTION
	812501		Assembly
1	812502	1	INNER LEG
2	812503	1	OUTER LEG
3	812401	1	PIPE ROLLER
4	812601	1	ROLLER SHAFT
5	MCH00004	2	1/8" DIA. x 1 1/4 LG COTTER PIN

DRAWING REVISION HISTORY LISTING

PART NO: 812501
DESCRIPTION: 2" - 8" PIPE STAND ASSEMBLY

<u>APPR.</u>	<u>REV</u>	<u>DATE</u>	<u>BY</u>	<u>DESCRIPTION OF REVISION</u>
B	C	5/19/95	TLW	Scanned & reduced to 'A' size format. Created typed parts list.
SWB	D	03/22/05	BWW	CREATED EXPLODED ISOMETRIC VIEW AND ADDED NOTE 1 FOR CLARITY. REMOVED MFJ00002 WHICH IS NOW INCLUDED IN 812401.